

SKETCH/AREA TABLE ADDENDUM

Parcel No 1/22/07

File No 2809830

Property Address 28-36-27-KN-2123-23

City PALM BAY

County BREVARD

State FL

Zip 32907

Owner

Client Client Address 1098 CAMDEN AV NW

Appraiser Name JEC

Inspection Date PALM BAY

SUBJECT

IMPROVEMENTS SKETCH

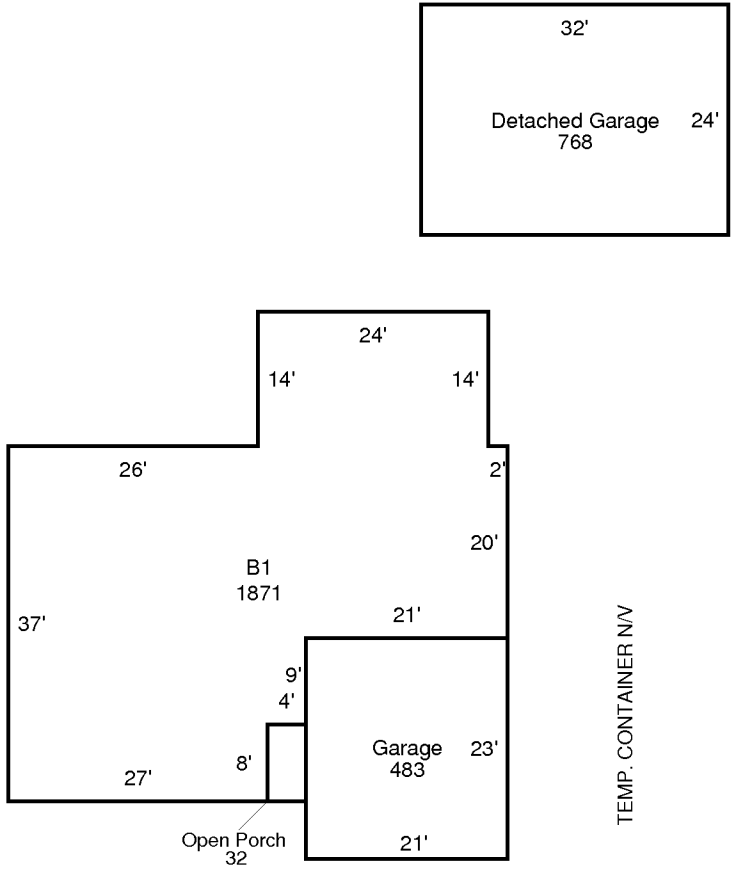

AREA CALCULATIONS

AREA CALCULATIONS SUMMARY

Code	Description	Factor	Net Size	Perimeter	Net Totals
B1	B1	1.00	1871	206	1871
GA	Garage	1.00	483	88	483
OP	Open Porch	1.00	32	24	32
GRGD	Detached Garage	1.00	768	112	768

Comment Table 1

--

Comment Table 2

Comment Table 3

--	--