

# SKETCH/AREA TABLE ADDENDUM

Parcel No 12/11/08

File No 2809780

Property Address 28-36-27-KN-1804-15

City PALMBAY

County BREVARD

State FL

Zip 32907

Owner PB0106902

Client 014

Client Address 1499 HEARTHWELLVILLE ST NW

Appraiser Name PHK

Inspection Date PALM BAY

NO F/C ALL ESTIMATED W/PICTOMETRY

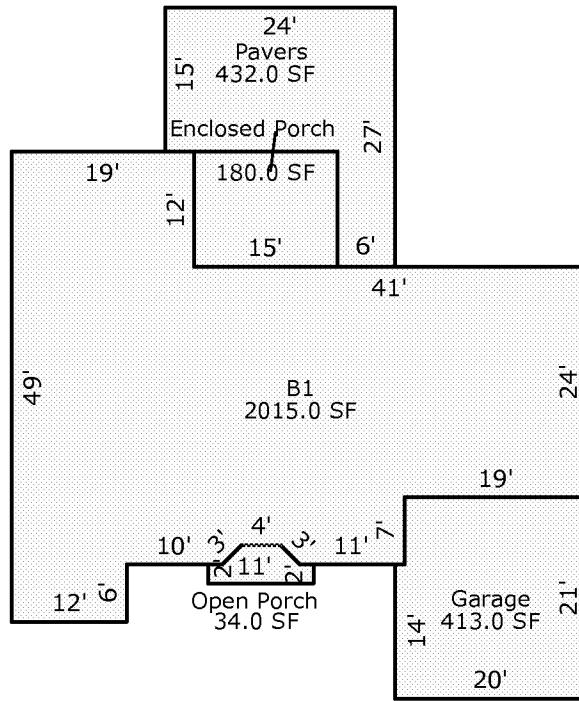

Scale: 1 = 20

## AREA CALCULATIONS SUMMARY

Code	Description	Factor	Net Size	Perimeter	Net Totals
B1	B1	1.00	2015.0	219.7	2015.0
GA	Garage	1.00	413.0	82.0	413.0
EP	Enclosed Porch	1.00	180.0	54.0	180.0
OP	Open Porch	1.00	34.0	27.7	34.0
PAVST	Pavers	1.00	432.0	102.0	432.0

AREA CALCULATIONS

SUBJECT

IMPROVEMENTS SKETCH