

SKETCH/AREA TABLE ADDENDUM

SUBJECT	PARCEL ID 28 3627KN 1802. 3.	CITY PALM BAY	COUNTY BREVARD	STATE FL	ZIP 32907
	PERMIT # NA				
	MARKET AREA 14	ADDRESS 1512 NW HEARTWELLVILLE ST			
	APPRAISER NAME EWI	BRANCH OFFICE PALM BAY			

IMPROVEMENTS SKETCH

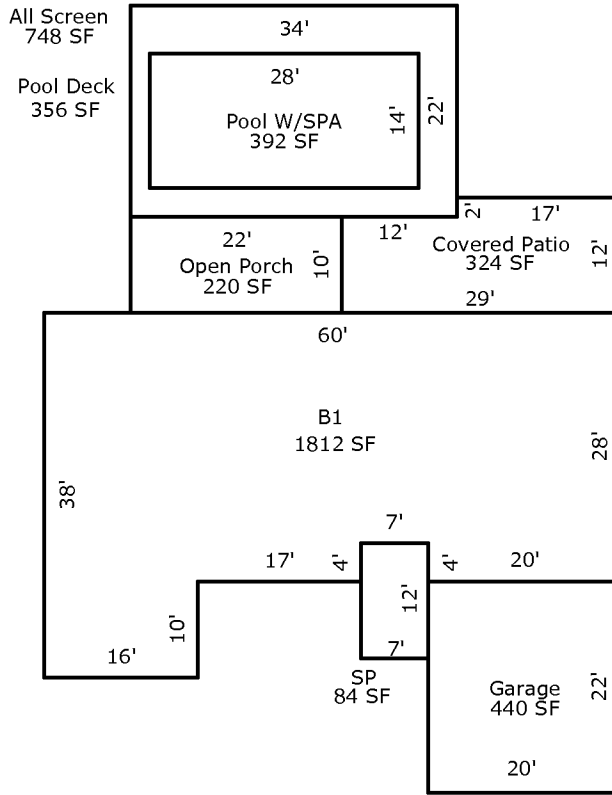

Scale: 1 = 20

AREA CALCULATIONS

AREA CALCULATIONS SUMMARY

Code	Description	Factor	Net Size	Perimeter	Net Totals
B1	B1	1.00	1812	204	1812
GA	Garage	1.00	440	84	440
OP	Open Porch	1.00	220	64	220
SP	SP	1.00	84	38	84
ALSCN	All Screen	1.00	748	112	748
CVPRT	Covered Patio	1.00	324	82	324
PDECK	Pool Deck	1.00	356	112	356
POOL	Pool W/SPA	1.00	392	84	392

Comment Table 1

--	--

Comment Table 2

Comment Table 3

--	--