

SKETCH/AREA TABLE ADDENDUM

Parcel No 6/19/09

File No 2805575

Property Address 283623KR2448 4

City PALM BAY

County BREVARD

State FL

Zip 32907

Owner N

Client 14

Client Address 397 JUPITER BLVD

Appraiser Name PHK

Inspection Date PALM BAY

NO F/C ALL ESTIMATED W/PICTOMETRY

SHED N/V

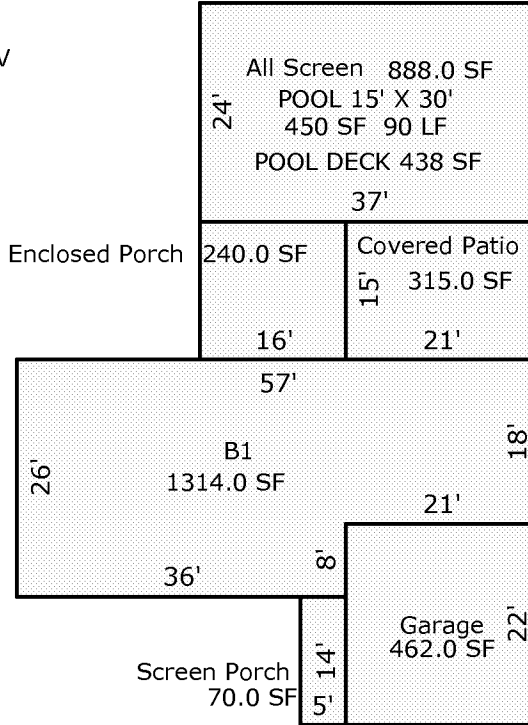

Scale: 1 = 21

AREA CALCULATIONS SUMMARY

Code	Description	Factor	Net Size	Perimeter	Net Totals
B1	B1	1.00	1314.0	166.0	1314.0
GA	Garage	1.00	462.0	86.0	462.0
EP	Enclosed Porch	1.00	240.0	62.0	240.0
SP	Screen Porch	1.00	70.0	38.0	70.0
ALSCN	All Screen	1.00	888.0	122.0	888.0
CVPRT	Covered Patio	1.00	315.0	72.0	315.0

Comment Table 1

--	--

Comment Table 2

Comment Table 3

--	--

AREA CALCULATIONS

SUBJECT

IMPROVEMENTS SKETCH