

SKETCH/AREA TABLE ADDENDUM

RE # 2804116

SUBJECT	PARCEL ID 28-36-22-KO-2233-11	CITY PALM BAY	COUNTY BREVARD	STATE FL	ZIP 32907
	PERMIT # NONE				
	MARKET AREA 144	ADDRESS 1625 FANNIN AV NW			
	APPRAISER NAME LPH	BRANCH OFFICE PALM BAY			

IMPROVEMENTS SKETCH

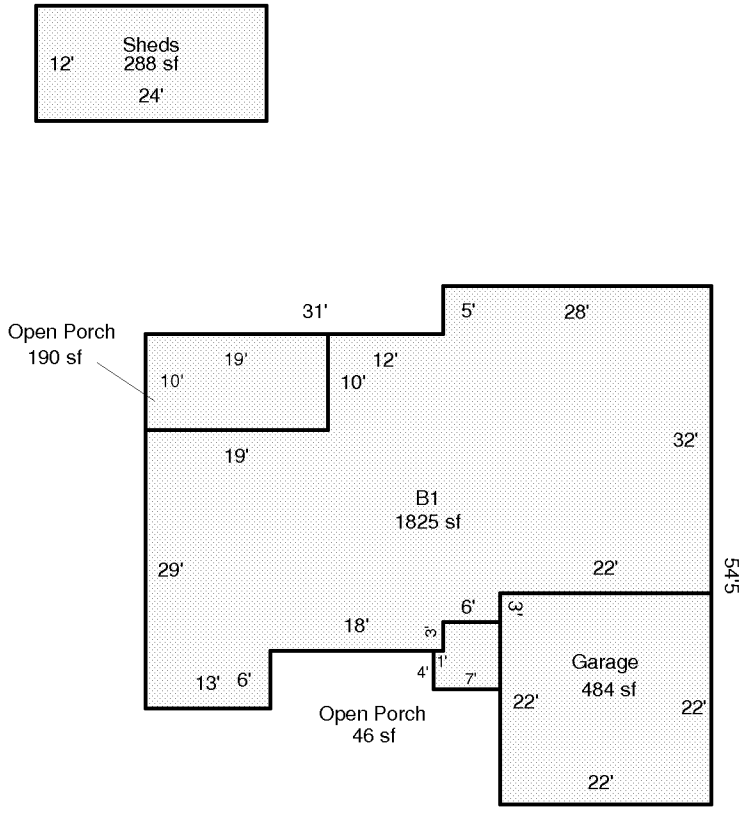

Scale: 1 = 20

AREA CALCULATIONS

AREA CALCULATIONS SUMMARY					
Code	Description	Factor	Net Size	Perimeter	Net Totals
B1	B1	1.00	1825	206	1825
GA	Garage	1.00	484	88	484
OP	Open Porch	1.00	190	58	
	Open Porch	1.00	46	28	236
SHED	Sheds	1.00	288	72	288

Comment Table 1	
Comment Table 2	Comment Table 3