

SKETCH/AREA TABLE ADDENDUM

File No 2803589

SUBJECT

Property Address	28-36-21-KO-2275-13		
City	PALM BAY	County	BREVARD
		State	FL
Owner	9906320		
Client		Client Address	1792 PARRSBORO ST NW
Appraiser Name	JOHN T	Inspection Date	VIERA

IMPROVEMENTS SKETCH

1/5/2000

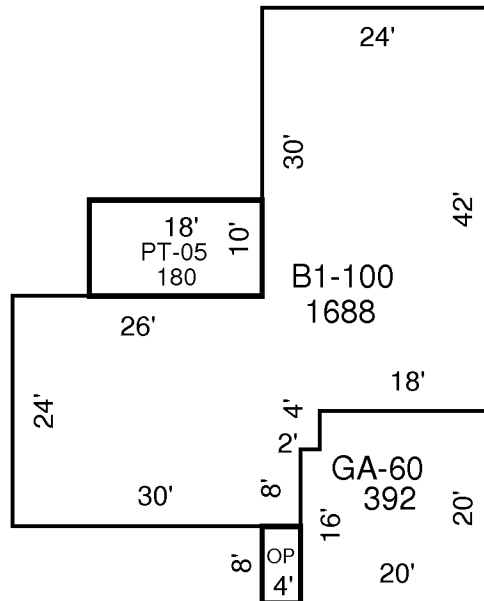

AREA CALCULATIONS

AREA CALCULATIONS SUMMARY

Code	Description	Factor	Net Size	Perimeter	Net Totals
B1	B1-100	1.00	1688	208	1688
GA7	GA-60	1.00	392	80	392
OP4	OP-30	1.00	32	24	32
PT	PT-05	1.00	180	56	180