

# SKETCH/AREA TABLE ADDENDUM

RE # 2803571

SUBJECT	PARCEL ID 283621KO 2274 23
	CITY PALM BAY COUNTY BREVARD STATE FL ZIP 32907
	PERMIT # NONE
	MARKET AREA 144 ADDRESS 1735 MACKLIN ST NW
	APPRAISER NAME LPH BRANCH OFFICE PALM BAY

IMPROVEMENTS SKETCH

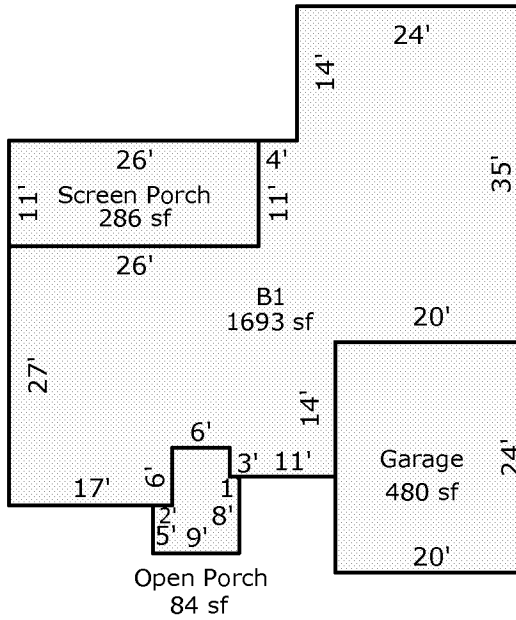

Scale: 1 = 20

AREA CALCULATIONS

### AREA CALCULATIONS SUMMARY

Code	Description	Factor	Net Size	Perimeter	Net Totals
B1	B1	1.00	1693	218	1693
GA	Garage	1.00	480	88	480
OP	Open Porch	1.00	84	40	84
SP	Screen Porch	1.00	286	74	286

#### Comment Table 1

#### Comment Table 2

#### Comment Table 3