

# SKETCH/AREA TABLE ADDENDUM

Parcel No 6/29/2011

File No 2729752

Property Address 27-37-34-25-H-6

City MELBOURNE

County BREVARD

State FL.

Zip 32901

Owner N/A

Client 125016

Client Address 720 WISTERIA DR.

Appraiser Name AEB

Inspection Date PALM BAY

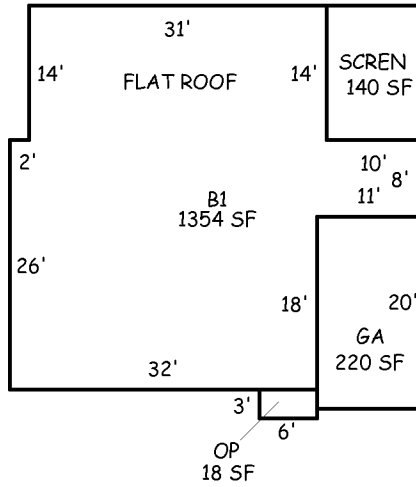

Scale: 1" = 12'

## AREA CALCULATIONS SUMMARY

Code	Description	Factor	Net Size	Perimeter	Net Totals
B1	B1	1.00	1354	166	1354
GA	Garage	1.00	220	62	220
OP	Open Porch	1.00	18	18	18
SCREN	Screen Enclosure	1.00	140	48	140

### Comment Table 1

--

### Comment Table 2

### Comment Table 3

--	--

AREA CALCULATIONS

SUBJECT

IMPROVEMENTS SKETCH