

SKETCH/AREA TABLE ADDENDUM

RE # 2726024

SUBJECT	PARCEL ID 27372425 4 10	COUNTY BREVARD	STATE FL	ZIP 32903
	CITY INDIALANTIC			
	PERMIT # NONE			
	MARKET AREA 208	ADDRESS 534 HUMMINGBIRD DR		
	APPRAISER NAME LPH	BRANCH OFFICE PALM BAY		

IMPROVEMENTS SKETCH

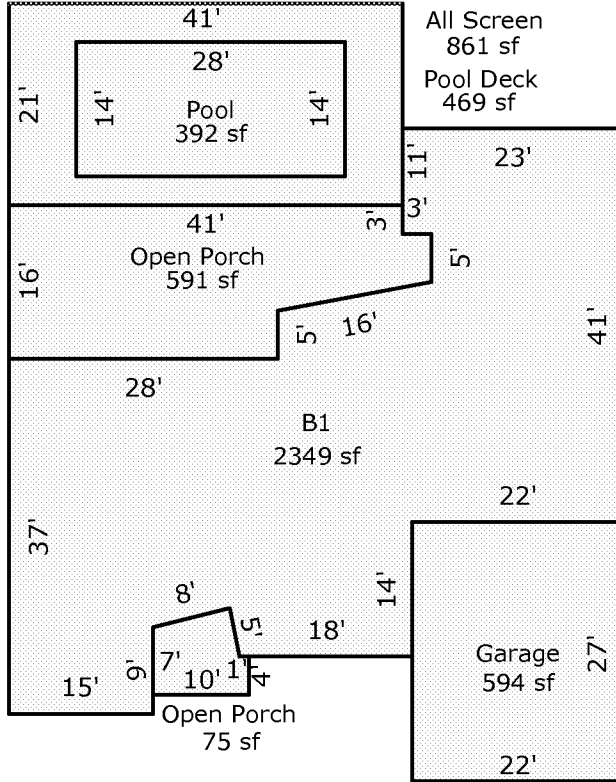

Scale: 1 = 20

AREA CALCULATIONS

AREA CALCULATIONS SUMMARY

Code	Description	Factor	Net Size	Perimeter	Net Totals
B1	B1	1.00	2349	261	2349
GA	Garage	1.00	594	98	594
OP	Open Porch	1.00	75	35	
	Open Porch	1.00	591	117	666
ALSCN	All Screen	1.00	861	124	861
PDECK	Pool Deck	1.00	469	124	469
POOL	Pool	1.00	392	84	392

Comment Table 1

--

Comment Table 2

Comment Table 3

--	--