

SKETCH/AREA TABLE ADDENDUM

Parcel No 12/18/08

File No 2725690

Property Address 27-37-24-00-24.9

City MELBOURNE

County BREVARD

State FL

Zip 32903

Owner RE-CHECK

Client 20

Client Address 255 PARADISE BLVD #9

Appraiser Name JEC

Inspection Date PALM BAY

RE-DRAWN FROM GREEN CARD NO F/C

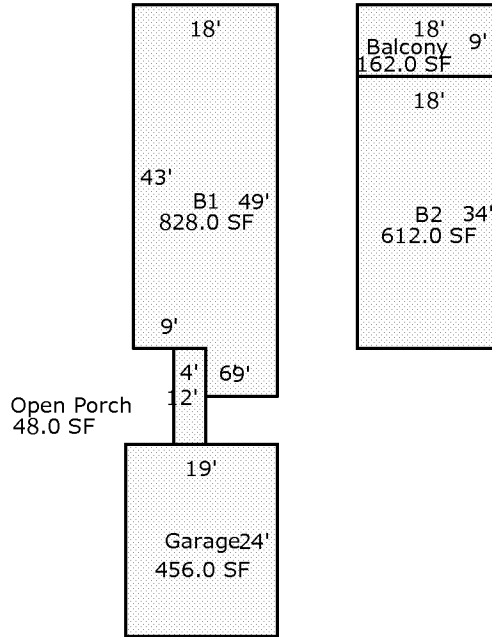

Scale: 1 = 24

AREA CALCULATIONS SUMMARY

Code	Description	Factor	Net Size	Perimeter	Net Totals
B1	B1	1.00	828.0	134.0	828.0
B2	B2	1.00	612.0	104.0	612.0
GA	Garage	1.00	456.0	86.0	456.0
OP	Open Porch	1.00	48.0	32.0	48.0
BC	Balcony	1.00	162.0	54.0	162.0

Comment Table 1

--	--

Comment Table 2

Comment Table 3

--	--

AREA CALCULATIONS

IMPROVEMENTS SKETCH

SUBJECT