

SKETCH/AREA TABLE ADDENDUM

Date 7/21/09

RE # 2719366

SUBJECT

Parcel ID	273818 00-759		
City	MELBOURNE	County	BREVARD
		State	FL
Permit #	NONE		
Market Area	111052	Address	2325 AURORA RD
Appraiser Name	LPH	Branch Office	PALM BAY

IMPROVEMENTS SKETCH

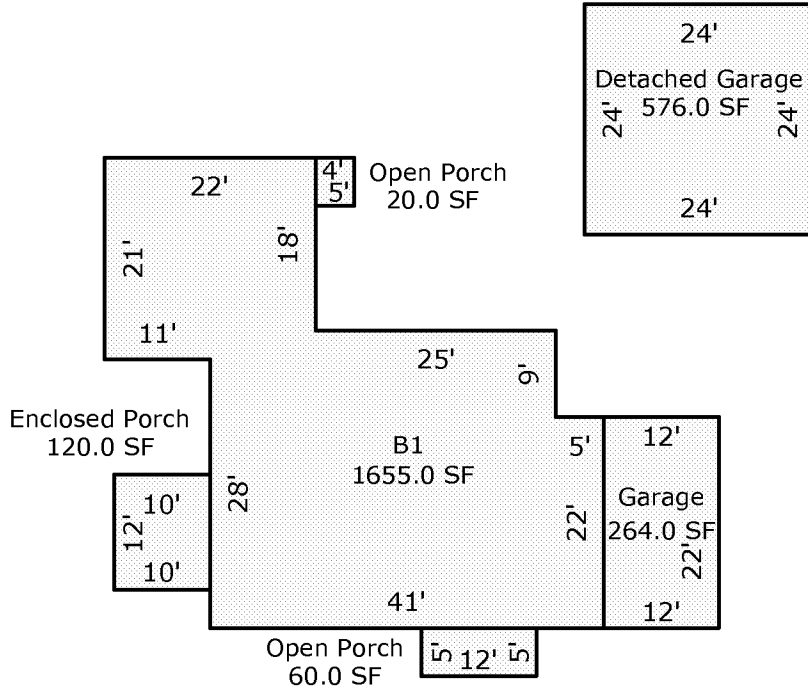

Scale: 1 = 20

AREA CALCULATIONS

AREA CALCULATIONS SUMMARY

Code	Description	Factor	Net Size	Perimeter	Net Totals
B1	B1	1.00	1655.0	202.0	1655.0
GA	Garage	1.00	264.0	68.0	264.0
EP	Enclosed Porch	1.00	120.0	44.0	120.0
OP	Open Porch	1.00	60.0	34.0	
	Open Porch	1.00	20.0	18.0	80.0
GRGD	Detached Garage	1.00	576.0	96.0	576.0

Comment Table 1

--	--

Comment Table 2

Comment Table 3

--	--