

# SKETCH/AREA TABLE ADDENDUM

Date 7/16/09

RE # 2702254

SUBJECT

Parcel ID 27-36-12-78\*-10

City MELBOURNE

County BREVARD

State FL

Zip 32934

Permit # NA

Market Area 10

Address 2235 WOODLAWN CIR

Appraiser Name EWI

Branch Office PALM BAY

EST FROM PICTOMETRY

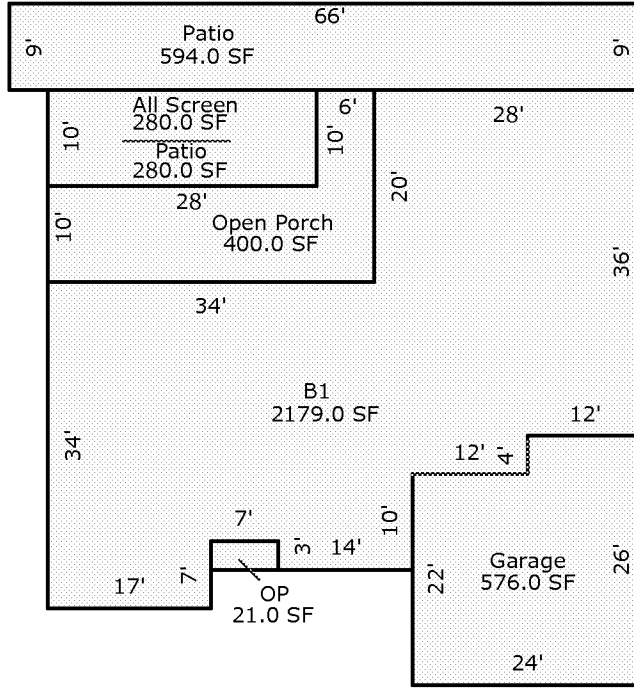

IMPROVEMENTS SKETCH

Scale: 1 = 20

AREA CALCULATIONS

### AREA CALCULATIONS SUMMARY

Code	Description	Factor	Net Size	Perimeter	Net Totals
B1	B1	1.00	2179.0	238.0	2179.0
GA	Garage	1.00	576.0	100.0	576.0
OP	Open Porch	1.00	400.0	108.0	421.0
PT	Patio	1.00	280.0	76.0	280.0
	Patio	1.00	594.0	150.0	874.0
ALSCN	All Screen	1.00	280.0	76.0	280.0

Comment Table 1

Comment Table 2

Comment Table 3