

# SKETCH/AREA TABLE ADDENDUM

DATE 26 JAN. 2011

RE # 2629602

SUBJECT

PARCEL ID 26 3605US B 3			
CITY MELBOURNE	COUNTY BREVARD	STATE FL	ZIP 32940
PERMIT # 10BC05913			
MARKET AREA 09	ADDRESS 6162 GOLETA CIR.		
APPRAISER NAME WHS	BRANCH OFFICE TITUSVILLE		

IMPROVEMENTS SKETCH

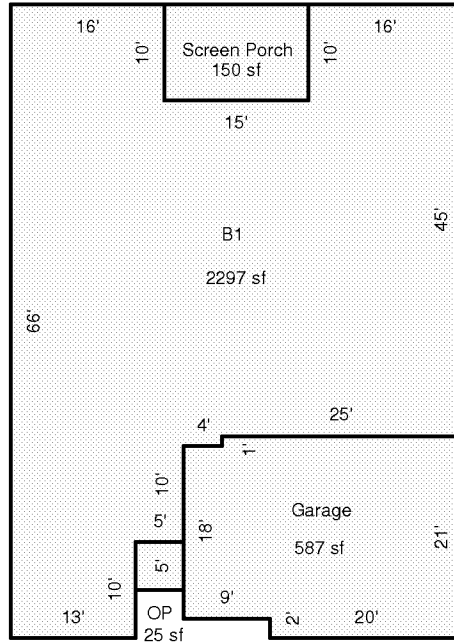

Scale: 1 = 20

AREA CALCULATIONS

### AREA CALCULATIONS SUMMARY

Code	Description	Factor	Net Size	Perimeter	Net Totals
B1	B1	1.00	2297	246	2297
GA	Garage	1.00	587	100	587
OP	OP	1.00	25	20	25
SP	Screen Porch	1.00	150	50	150

#### Comment Table 1

--

#### Comment Table 2

#### Comment Table 3

--	--