

# SKETCH/AREA TABLE ADDENDUM

Parcel No 2/11/09

File No 2627552

Property Address 26 360851 e 12

City VIERA

County BREVARD

State FLORIDA

Zip 32940

Owner 08BC01639

Client 9

Client Address 7137 BRODERICK DR

Appraiser Name GAC

Inspection Date PALM BAY

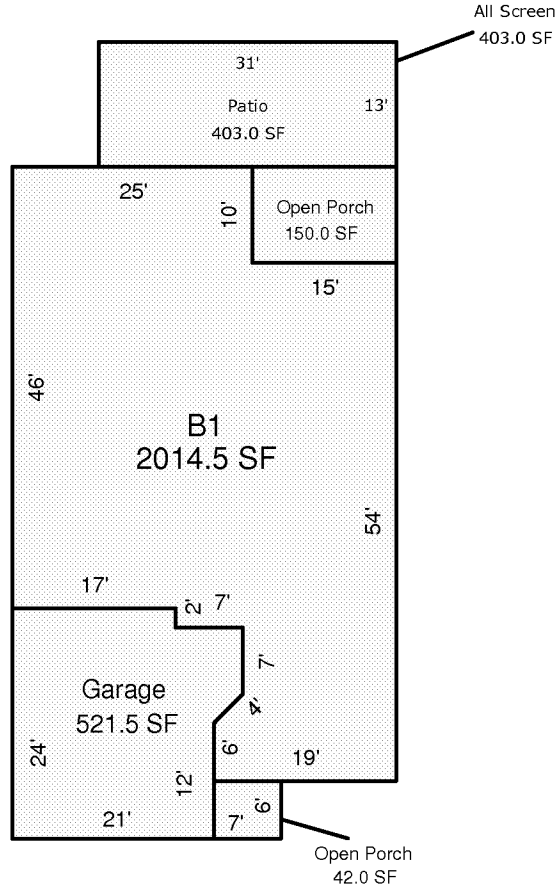

Scale: 1 = 20

## AREA CALCULATIONS SUMMARY

Code	Description	Factor	Net Size	Perimeter	Net Totals
B1	B1	1.00	2014.5	212.2	2014.5
GA	Garage	1.00	521.5	94.2	521.5
OP	Open Porch	1.00	42.0	26.0	
	Open Porch	1.00	150.0	50.0	192.0
PT	Patio	1.00	403.0	88.0	403.0
ALSCN	All Screen	1.00	403.0	88.0	403.0

### Comment Table 1

### Comment Table 2

### Comment Table 3

AREA CALCULATIONS

SUBJECT

IMPROVEMENTS SKETCH