

SKETCH/AREA TABLE ADDENDUM

Parcel No 3/21/07

File No 2627548

Property Address 26 360851 E 8

City VIERA County BREVARD State FLORIDA Zip

Owner M0191791

Client Client Address 7177 BRODERICK DR

Appraiser Name PHK Inspection Date PALM BAY

SUBJECT

IMPROVEMENTS SKETCH

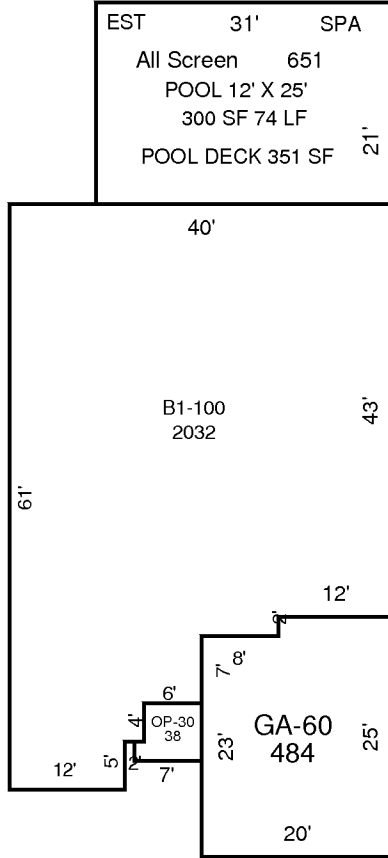

AREA CALCULATIONS

AREA CALCULATIONS SUMMARY

Code	Description	Factor	Net Size	Perimeter	Net Totals
B1	B1-100	1.00	2032	202	2032
ALSCN	All Screen	1.00	651	104	651
GA7	GA-60	1.00	484	90	484
OP4	OP-30	1.00	38	26	38

Comment Table 1

--	--

Comment Table 2

Comment Table 3

--	--