

# SKETCH/AREA TABLE ADDENDUM

File No 26243751

SUBJECT

Property Address	26-36-26-SJ-W-15W		
City	County	BREVARD	State
Owner	SFR 12-3-01 OCO119868 \$120,000		
Client	Client Address 4107 FOUR LAKES DRIVE		
Appraiser Name	GLENN LEGGE	Inspection Date	VIERA (PERMITS)

IMPROVEMENTS SKETCH

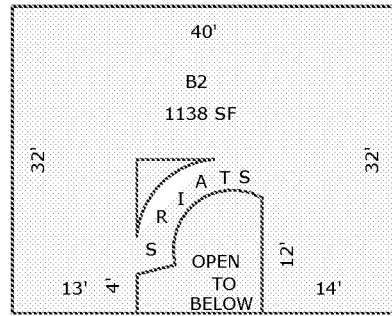
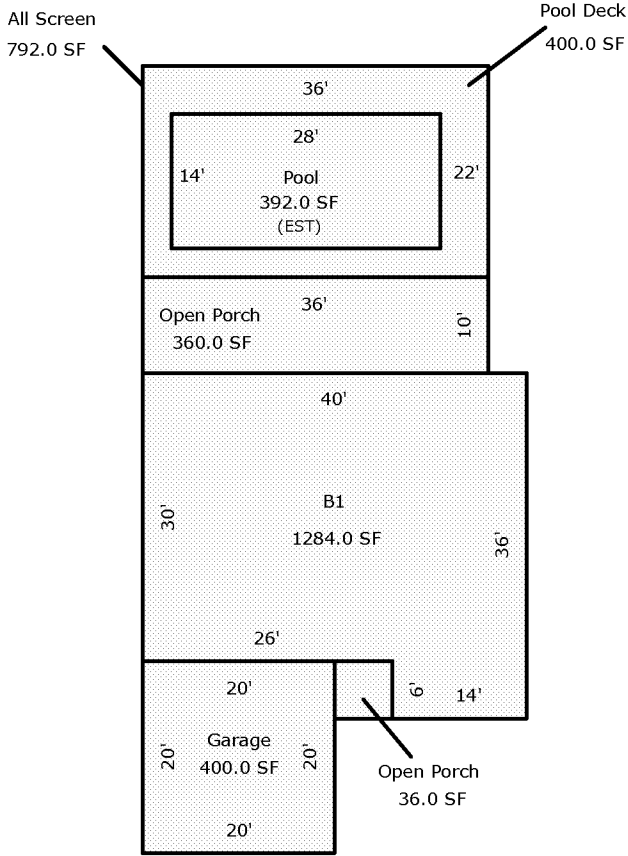

Scale: 1 = 20

AREA CALCULATIONS

## AREA CALCULATIONS SUMMARY

Code	Description	Factor	Net Size	Perimeter	Net Totals
B1	B1	1.00	1284.0	152.0	1284.0
B2	B2-100	1.00	1154.2	165.6	
	B2-100	1.00	-16.1	28.3	1138.1
GA	Garage	1.00	400.0	80.0	400.0
OP	Open Porch	1.00	36.0	24.0	
	Open Porch	1.00	360.0	92.0	396.0
ALSCN	All Screen	1.00	792.0	116.0	792.0
PDECK	Pool Deck	1.00	400.0	116.0	400.0
POOL	Pool	1.00	392.0	84.0	392.0
