

SKETCH/AREA TABLE ADDENDUM

File No 26233791

SUBJECT

Property Address	26-36-03-RR-A-51		
City	County	State	Zip
	BREVARD	FL	
Owner	SFR 5-12-00 OCO097910 \$87,400		
Client	Client Address 1825 BAYHILL DRIVE		
Appraiser Name	GLENN LEGGE	Inspection Date	VIERA, (PERMITS)

IMPROVEMENTS SKETCH

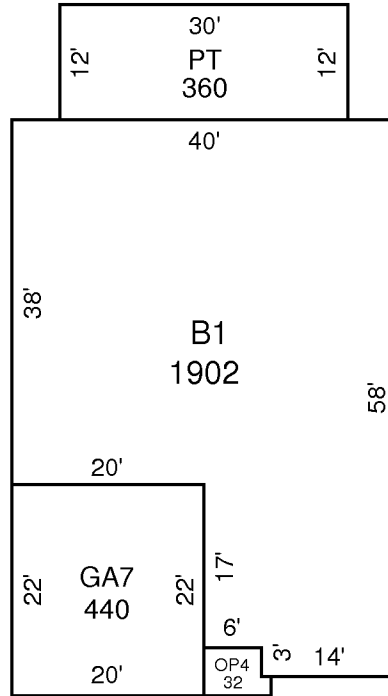

DRAWN: GNL 8-8-00

AREA CALCULATIONS

AREA CALCULATIONS SUMMARY

Code	Description	Factor	Net Size	Perimeter	Net Totals
B1	B1-100	1.00	1902	196	1902
GA7	GA-60	1.00	440	84	440
OP4	OP-30	1.00	32	24	32
PT	PT-05	1.00	360	84	360