

SKETCH/AREA TABLE ADDENDUM

RE # 26226861

SUBJECT	PARCEL ID 26-36-02-77 319	CITY MELBOURNE	COUNTY BREVARD	STATE FL	ZIP 32940
	PERMIT # NONE				
	MARKET AREA 092084	ADDRESS 862 CORAL SPRINGS STREET			
	APPRAISER NAME LPH	BRANCH OFFICE PALM BAY			

IMPROVEMENTS SKETCH

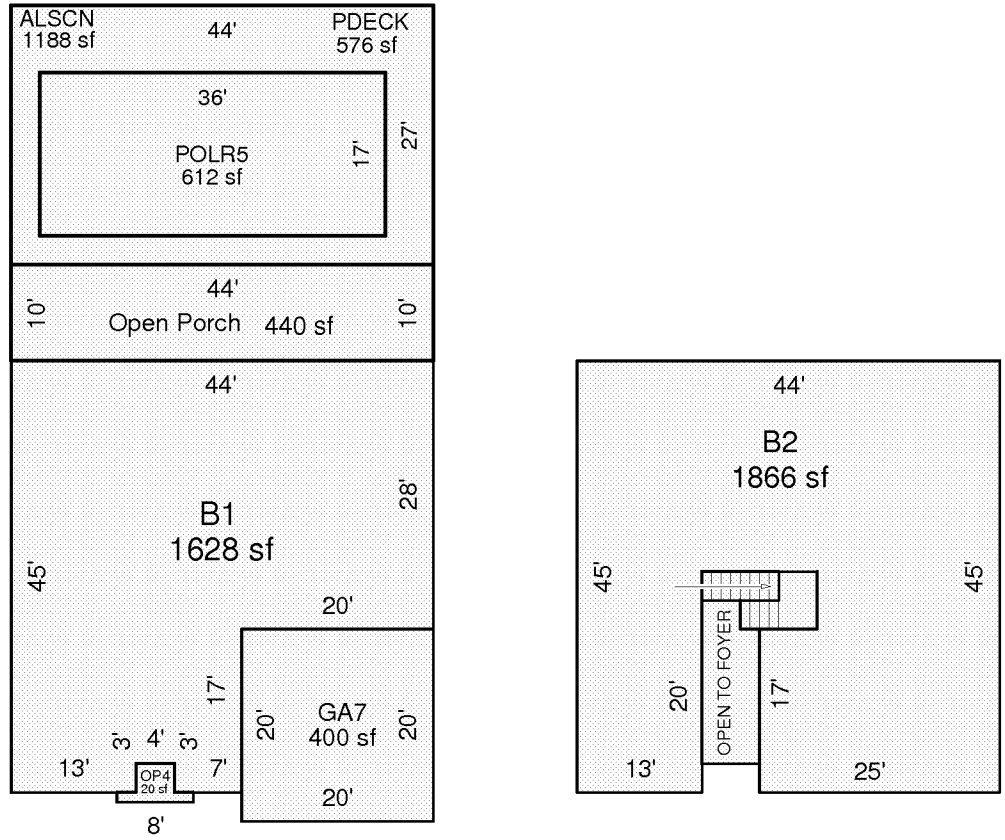

Scale: 1 = 20

AREA CALCULATIONS

AREA CALCULATIONS SUMMARY

Code	Description	Factor	Net Size	Perimeter	Net Totals
B1	B1-100	1.00	1628	184	1628
B2	B2-100	1.00	1866	218	1866
OP	Open Porch	1.00	440	108	440
ALSCN	ALSCN	1.00	1188	142	1188
PDECK	PDECK	1.00	576	142	576
POOL	POLR5	1.00	612	106	612
OP4	OP-30	1.00	20	24	20
GA7	GA-60	1.00	400	80	400
