

SKETCH/AREA TABLE ADDENDUM

RE # 26226831

SUBJECT	PARCEL ID 26-36-02-77 316	CITY MELBOURNE	COUNTY BREVARD	STATE FL	ZIP 32940
	PERMIT # NONE				
	MARKET AREA 092084	ADDRESS 892 CORAL SPRINGS STREET			
	APPRAISER NAME LPH	BRANCH OFFICE PALM BAY			

IMPROVEMENTS SKETCH

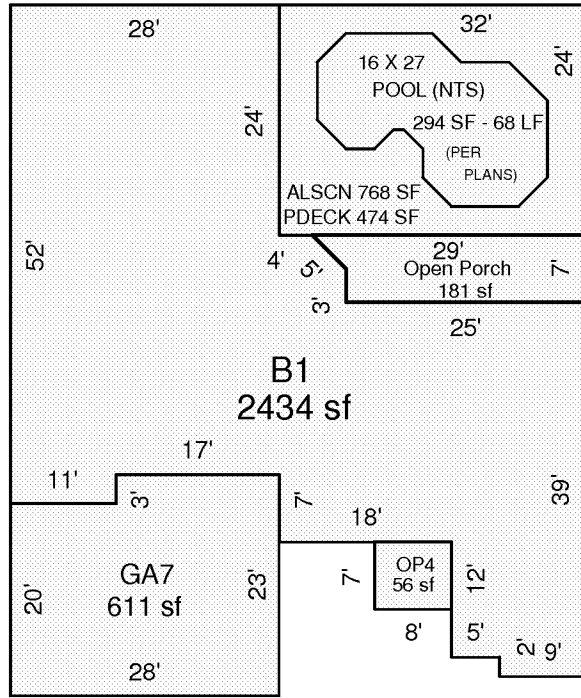

DRAWN: GNL 10-17-01

Scale: 1 = 20

AREA CALCULATIONS

AREA CALCULATIONS SUMMARY

Code	Description	Factor	Net Size	Perimeter	Net Totals
B1	B1-100	1.00	2434	264	2434
OP	Open Porch	1.00	181	69	181
OP4	OP-30	1.00	56	30	56
GA7	GA-60	1.00	611	102	611
