

SKETCH/AREA TABLE ADDENDUM

File No 2619529

Property Address 26-36-26-25-B-7

City County BREVARD State FL Zip

Owner Client Address 4104 STONEY POINT RD

Appraiser Name JCT Inspection Date VIERA

1/17/2006

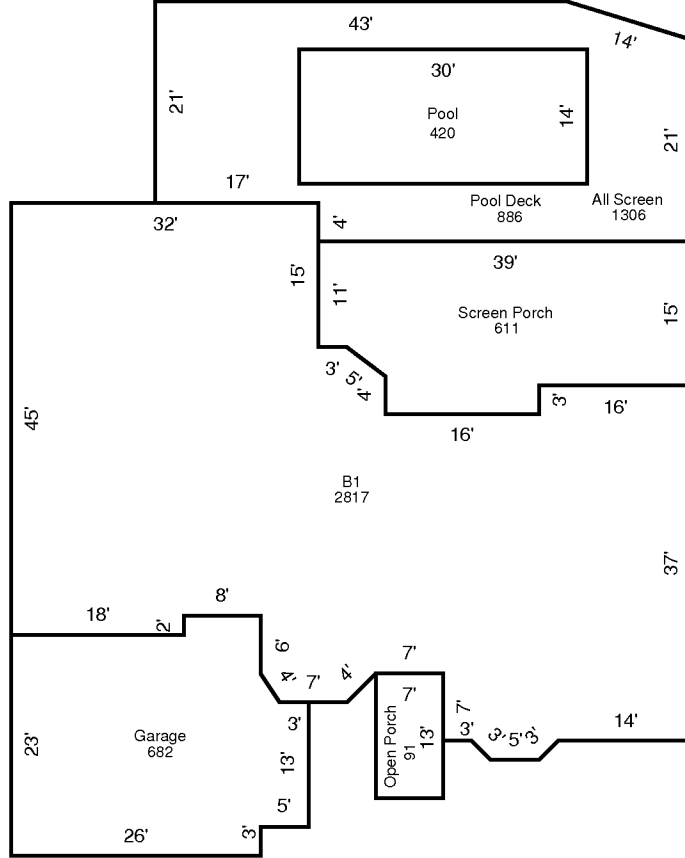

AREA CALCULATIONS SUMMARY

Code	Description	Factor	Net Size	Perimeter	Net Totals
B1	B1	1.00	2817	267	2817
GA	Garage	1.00	682	111	682
OP	Open Porch	1.00	91	40	91
SP	Screen Porch	1.00	611	112	611
ALSCN	All Screen	1.00	1306	159	1306
PDECK	Pool Deck	1.00	886	159	886
POOL	Pool	1.00	420	88	420

Comment Table 1

--	--

Comment Table 2

Comment Table 3

--	--