

SKETCH/AREA TABLE ADDENDUM

File No 2615733

SUBJECT

Property Address	26361002B.8		
City	VIERA	County	BREVARD
		State	FL
Zip	32940		
Owner			
Client	Client Address 6721 Fawn Ridge Dr		
Appraiser Name	TAF	Inspection Date	M.I.

IMPROVEMENTS SKETCH

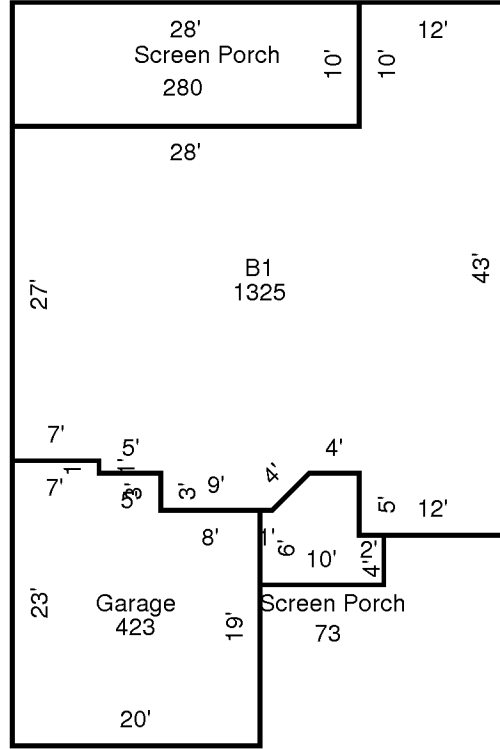

AREA CALCULATIONS

AREA CALCULATIONS SUMMARY					
Code	Description	Factor	Net Size	Perimeter	Net Totals
B1	B1	1.00	1325	170	1325
GA	Garage	1.00	423	86	423
SP	Screen Porch	1.00	280	76	
	Screen Porch	1.00	73	36	353

Comment Table 1	
Comment Table 2	Comment Table 3