

SKETCH/AREA TABLE ADDENDUM

File No 2615732

Property Address 26361002B.7

City VIERA

County BREVARD

State FL

Zip 32940

Owner

Client

Client Address 6731 Fawn Ridge Dr

Appraiser Name TAF

Inspection Date M.I.

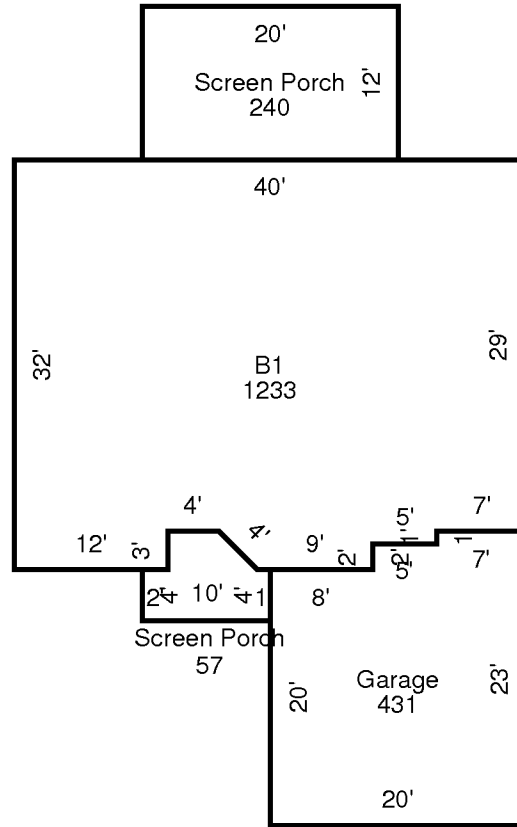

AREA CALCULATIONS SUMMARY

Code	Description	Factor	Net Size	Perimeter	Net Totals
B1	B1	1.00	1233	148	1233
GA	Garage	1.00	431	86	431
SP	Screen Porch	1.00	57	32	
	Screen Porch	1.00	240	64	297

Comment Table 1

Comment Table 2

Comment Table 3