

SKETCH/AREA TABLE ADDENDUM

DATE 2/9/10

RE # 2615731

SUBJECT

PARCEL ID 26 361002 B 6	COUNTY Brevard	STATE FL	ZIP 32940
CITY MELBOURNE	ADDRESS 6741 FAWN RIDGE DR.		
PERMIT # N	BRANCH OFFICE PALM BAY		
MARKET AREA 09			
APPRaiser NAME PHK			

IMPROVEMENTS SKETCH

NO F/C ALL ESTIMATED W/PICTOMETRY

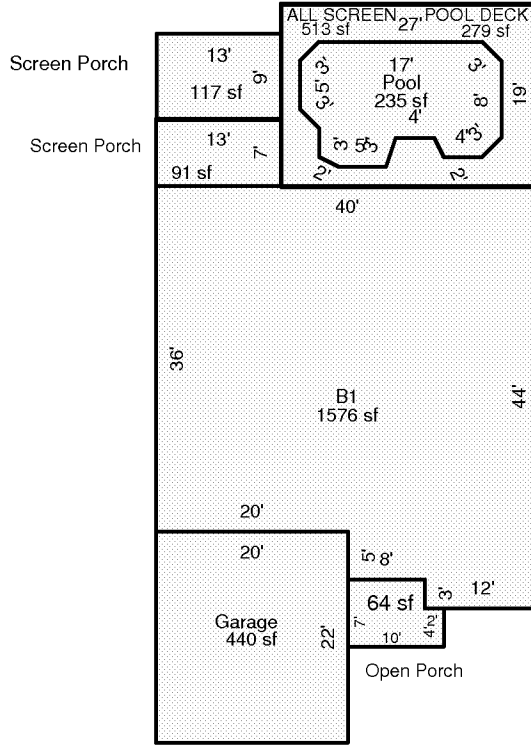

Scale: 1 = 20

AREA CALCULATIONS

AREA CALCULATIONS SUMMARY

Code	Description	Factor	Net Size	Perimeter	Net Totals
B1	B1	1.00	1576	168	1576
GA	Garage	1.00	440	84	440
OP	Open Porch	1.00	64	34	64
SP	Screen Porch	1.00	91	40	
	Screen Porch	1.00	117	44	208
ALSCN	ALL SCREEN	1.00	513	92	513
PDECK	POOL DECK	1.00	279	92	279
POOL	Pool	1.00	235	65	235

Comment Table 1

--	--

Comment Table 2

Comment Table 3

--	--