

SKETCH/AREA TABLE ADDENDUM

File No 2615730

SUBJECT

Property Address	26361002B.5	County	BREVARD	State	FL	Zip	32940
City	VIERA						
Owner							
Client		Client Address	6751 Fawn Ridge Dr				
Appraiser Name	TAF	Inspection Date	M.I.				

IMPROVEMENTS SKETCH

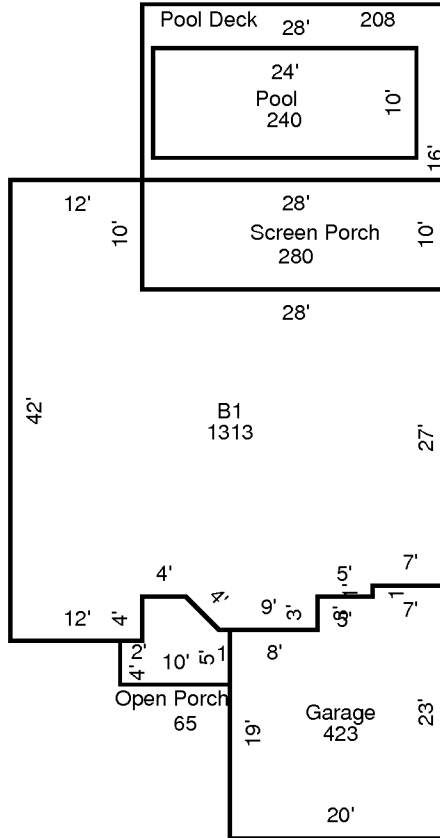

AREA CALCULATIONS

AREA CALCULATIONS SUMMARY

Code	Description	Factor	Net Size	Perimeter	Net Totals
B1	B1	1.00	1313	168	1313
GA	Garage	1.00	423	86	423
OP	Open Porch	1.00	65	34	65
SP	Screen Porch	1.00	280	76	280
PDECK	Pool Deck	1.00	208	88	208
POOL	Pool	1.00	240	68	240

Comment Table 1

--	--

Comment Table 2

Comment Table 3

--	--