

SKETCH/AREA TABLE ADDENDUM

File No 2615715

Property Address 26361002A.11

City VIERA

County BREVARD

State FL

Zip 32940

Owner

Client

Client Address 6702 Fawn Ridge Dr

Appraiser Name TAF

Inspection Date M.I.

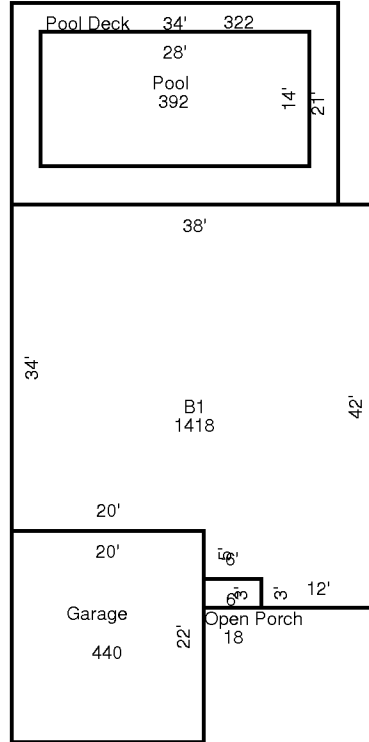

AREA CALCULATIONS SUMMARY

Code	Description	Factor	Net Size	Perimeter	Net Totals
B1	B1	1.00	1418	160	1418
GA	Garage	1.00	440	84	440
OP	Open Porch	1.00	18	18	18
PDECK	Pool Deck	1.00	322	110	322
POOL	Pool	1.00	392	84	392

Comment Table 1

Comment Table 2

Comment Table 3