

SKETCH/AREA TABLE ADDENDUM

File No 26141531

SUBJECT

Property Address 26-36-04-OY-H-21			
City	County BREVARD	State FL	Zip
Owner SFR 4-19-00 OCOO96879 \$130,000			
Client	Client Address 2111 LIONEL DRIVE		
Appraiser Name GLENN LEGGE	Inspection Date VIERA, (PERMITS)		

IMPROVEMENTS SKETCH

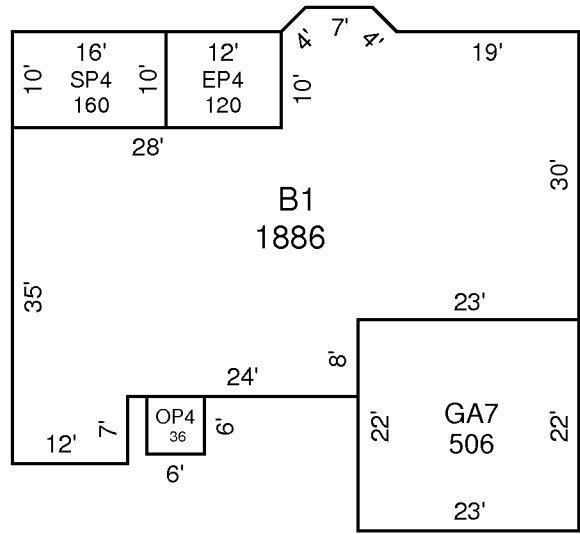

DRAWN: GNL 6-15-00

AREA CALCULATIONS

AREA CALCULATIONS SUMMARY					
Code	Description	Factor	Net Size	Perimeter	Net Totals
B1	B1-100	1.00	1886	210	1886
GA7	GA-60	1.00	506	90	506
OP4	OP-30	1.00	36	24	36
EP4	EP-70	1.00	120	44	120
SP4	SP-40	1.00	160	52	160
