

# SKETCH/AREA TABLE ADDENDUM

File No 2609769

SUBJECT

Property Address	26-37-30-OL-6-1		
City	PALM SHORES	County	BREVARD
		State	FL
Owner	MJ0001491		
Client	Client Address 2375 HIGH RIDGE RD		
Appraiser Name	JOHN T	Inspection Date	VIERA

2/29/2000

IMPROVEMENTS SKETCH

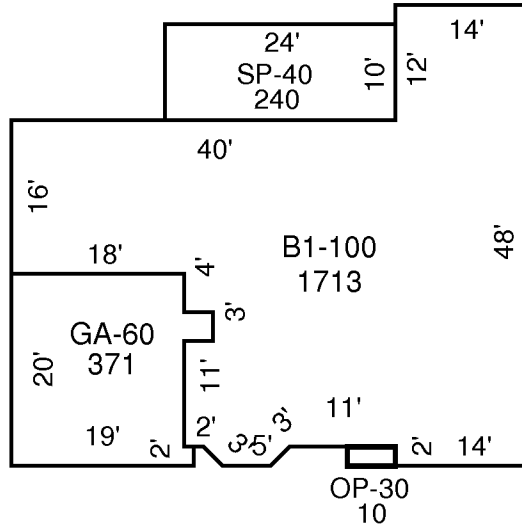

AREA CALCULATIONS

## AREA CALCULATIONS SUMMARY

Code	Description	Factor	Net Size	Perimeter	Net Totals
B1	B1-100	1.00	1713	212	1713
GA7	GA-60	1.00	371	84	371
OP4	OP-30	1.00	10	14	10
SP4	SP-40	1.00	240	68	240