

SKETCH/AREA TABLE ADDENDUM

DATE 02.03.11

RE # 2601774

SUBJECT

| | | | |
|--|----------------|------------------------------|-----------|
| PARCEL ID 26 361202 C | COUNTY BREVARD | STATE FL | ZIP 32955 |
| CITY ROCKLEDGE | | | |
| PERMIT # M0175975,M0175963,M0175969,M0176051 | | | |
| MARKET AREA 09 | | ADDRESS 6261 LA CAPRIA LN. | |
| APPRAISER NAME JCA | | BRANCH OFFICE MERRITT ISLAND | |

IMPROVEMENTS SKETCH

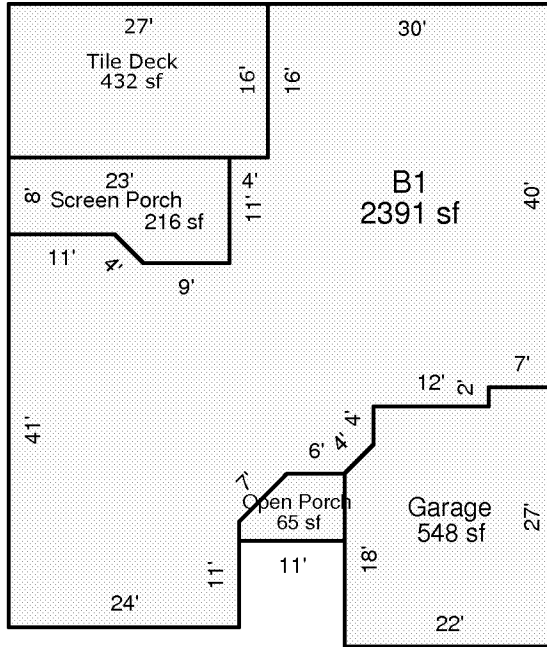

Scale: 1 = 20

AREA CALCULATIONS

AREA CALCULATIONS SUMMARY

| Code | Description | Factor | Net Size | Perimeter | Net Totals |
|-------|--------------|--------|----------|-----------|------------|
| B1 | B1 | 1.00 | 2391 | 244 | 2391 |
| GA | Garage | 1.00 | 548 | 96 | 548 |
| OP | Open Porch | 1.00 | 65 | 33 | 65 |
| SP | Screen Porch | 1.00 | 216 | 66 | 216 |
| TDECK | Tile Deck | 1.00 | 432 | 86 | 432 |

Comment Table 1

| | |
|--|--|
| | |
|--|--|

Comment Table 2

Comment Table 3

| | |
|--|--|
| | |
|--|--|

SKETCH/AREA TABLE ADDENDUM

Parcel No 11-30-07

File No 2601774

Property Address 26 361202 C

City ROCKLEDGE

County Brevard

State FL

Zip 32955

Owner M0175975,M0175963,M0175969,M0176051

Client 09

Client Address 6261 LA CAPRIA

Appraiser Name JCA

Inspection Date MERRITT ISLAND

SUBJECT

IMPROVEMENTS SKETCH

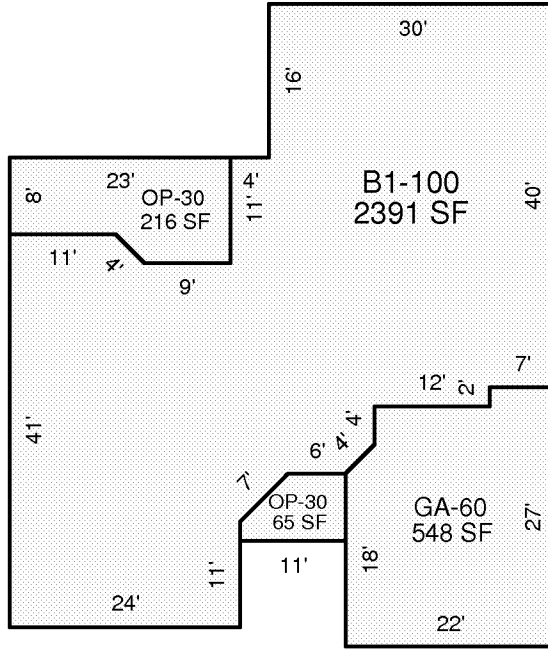

Pdc 2 of 3
PERMIT #M0175969

Scale: 1 = 20

AREA CALCULATIONS

AREA CALCULATIONS SUMMARY

| Code | Description | Factor | Net Size | Perimeter | Net Totals |
|------|-------------|--------|----------|-----------|------------|
| B1 | B1-100 | 1.00 | 2390.5 | 243.6 | 2390.5 |
| GA7 | GA-60 | 1.00 | 547.5 | 96.2 | 547.5 |
| OP4 | OP-30 | 1.00 | 64.5 | 33.1 | |
| | OP-30 | 1.00 | 215.5 | 66.2 | 280.0 |

Comment Table 1

| | |
|--|--|
| | |
|--|--|

Comment Table 2

Comment Table 3

| | |
|--|--|
| | |
|--|--|

SKETCH/AREA TABLE ADDENDUM

Parcel No 11-30-07

File No 2601774

Property Address 26 361202 C

City ROCKLEDGE

County Brevard

State FL

Zip 32955

Owner M0175975,M0175963,M0175969,M0176051

Client 09

Client Address 6261 LA CAPRIA

Appraiser Name JCA

Inspection Date MERRITT ISLAND

SUBJECT

IMPROVEMENTS SKETCH

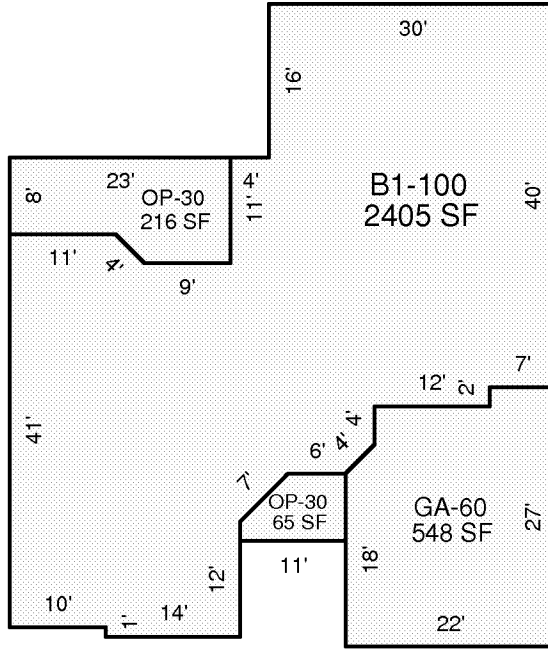

Pdc 3 of 3
PERMIT #M0176051

Scale: 1 = 20

AREA CALCULATIONS

AREA CALCULATIONS SUMMARY

| Code | Description | Factor | Net Size | Perimeter | Net Totals |
|------|-------------|--------|----------|-----------|------------|
| B1 | B1-100 | 1.00 | 2404.5 | 245.6 | 2404.5 |
| GA7 | GA-60 | 1.00 | 547.5 | 96.2 | 547.5 |
| OP4 | OP-30 | 1.00 | 64.5 | 33.1 | |
| | OP-30 | 1.00 | 215.5 | 66.2 | 280.0 |

Comment Table 1

| | |
|--|--|
| | |
|--|--|

Comment Table 2

Comment Table 3

| | |
|--|--|
| | |
|--|--|

SKETCH/AREA TABLE ADDENDUM

Parcel No 7-19-05

File No 2601774

Property Address 26 361202 C

City _____ County **Brevard** State **FL** Zip _____

Owner **M0175975,M0175963,M0175969,M0176051**

Client _____

Appraiser Name **Maria Becht** Inspection Date **Viera**

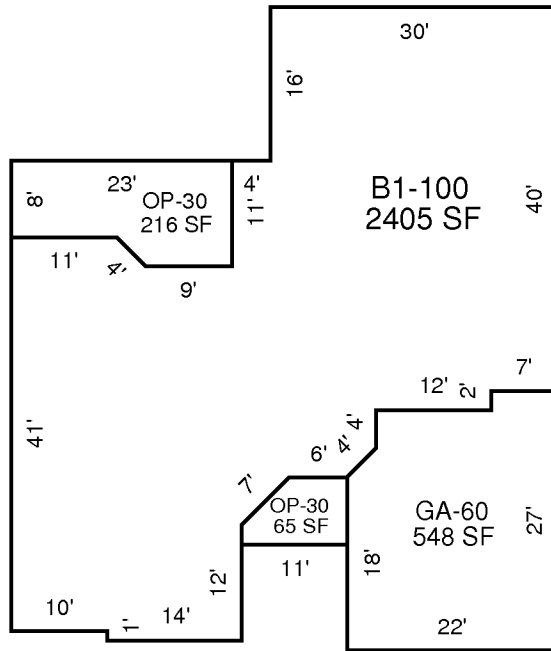

PDC 4 OF 4
PERMIT #M0176051

AREA CALCULATIONS SUMMARY

| Code | Description | Factor | Net Size | Perimeter | Net Totals |
|------|-------------|--------|----------|-----------|------------|
| B1 | B1-100 | 1.00 | 2405 | 246 | 2405 |
| GA7 | GA-60 | 1.00 | 548 | 96 | 548 |
| OP4 | OP-30 | 1.00 | 65 | 33 | |
| | OP-30 | 1.00 | 216 | 66 | 280 |

Comment Table 1

| |
|--|
| |
|--|

Comment Table 2

Comment Table 3

| | |
|--|--|
| | |
|--|--|