

# SKETCH/AREA TABLE ADDENDUM

DATE 11/16/09

RE # 2601011

SUBJECT

PARCEL ID	26-36-03-75-B-21		
CITY	COCOA	COUNTY	BREVARD
		STATE	FL
ZIP	32940		
PERMIT #	09BC03324		
MARKET AREA	092018	ADDRESS	1311 CONTINENTAL AVE
APPRAISER NAME	JEC	BRANCH OFFICE	VIERA

IMPROVEMENTS SKETCH

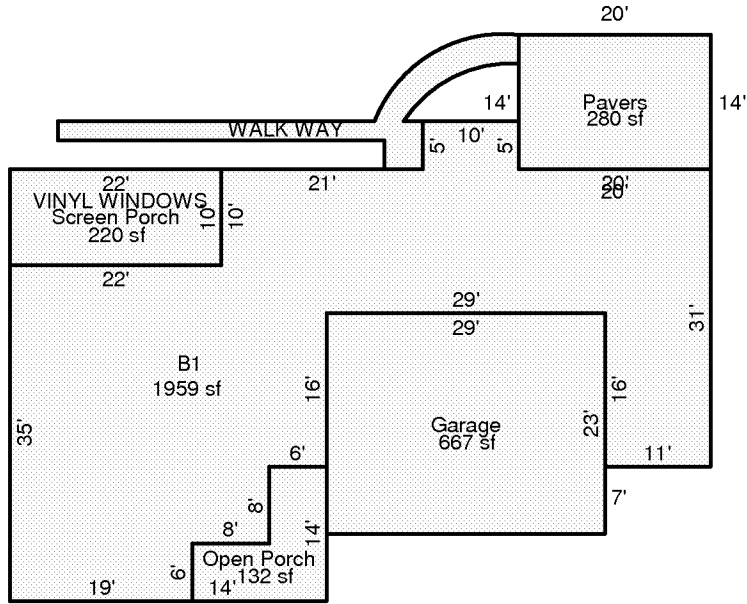

Scale: 1 = 20

AREA CALCULATIONS

### AREA CALCULATIONS SUMMARY

Code	Description	Factor	Net Size	Perimeter	Net Totals
B1	B1	1.00	1959	278	1959
GA	Garage	1.00	667	104	667
OP	Open Porch	1.00	132	56	132
SP	Screen Porch	1.00	220	64	220
PAVST	Pavers	1.00	280	68	280

### Comment Table 1

--	--

### Comment Table 2

### Comment Table 3

--	--