

# SKETCH/AREA TABLE ADDENDUM

DATE 2 NOV. 2009

RE # 2536497

SUBJECT

PARCEL ID 25 363550 E 25	COUNTY BREVARD	STATE FL	ZIP 32940
CITY MELBOURNE			
PERMIT # 09BC02784 ; 09BC04795			
MARKET AREA 09	ADDRESS 1766 CROGHAN DR.		
APPRAISER NAME WHS	BRANCH OFFICE TITUSVILLE		

IMPROVEMENTS SKETCH

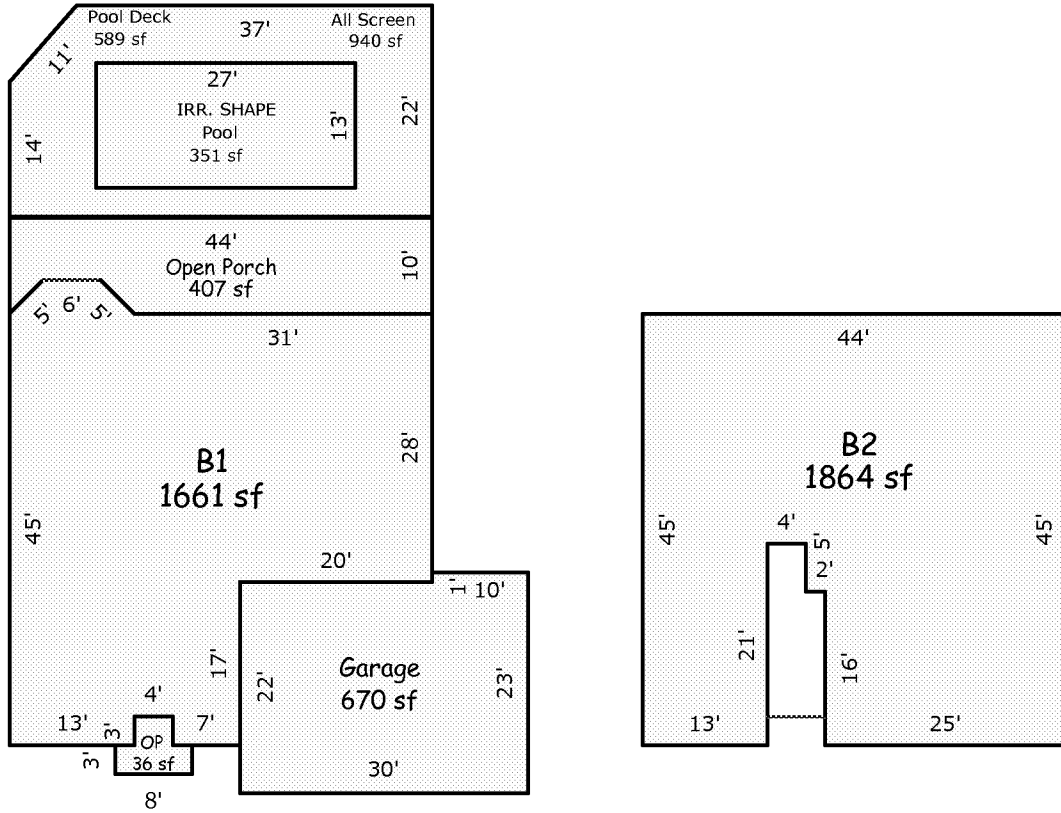

Scale: 1 = 20

AREA CALCULATIONS

### AREA CALCULATIONS SUMMARY

Code	Description	Factor	Net Size	Perimeter	Net Totals
B1	B1	1.00	1661	187	1661
B2	B2	1.00	1864	220	1864
GA	Garage	1.00	670	106	670
OP	OP	1.00	36	28	36
	Open Porch	1.00	407	111	443
ALSCN	All Screen	1.00	940	128	940
PDECK	Pool Deck	1.00	589	128	589
POOL	Pool	1.00	351	80	351

### Comment Table 1

--

### Comment Table 2

--

### Comment Table 3

--