

SKETCH/AREA TABLE ADDENDUM

DATE 3/23/10

RE # 2534363

SUBJECT	PARCEL ID 25-37-22-DP-G-7.01		
	CITY COCOA BEACH	COUNTY BREVARD	STATE FL
	PERMIT # RECHECK		
	MARKET AREA 17	ADDRESS 21 WEST POINT DR	
	APPRAISER NAME JEC	BRANCH OFFICE VIERA	

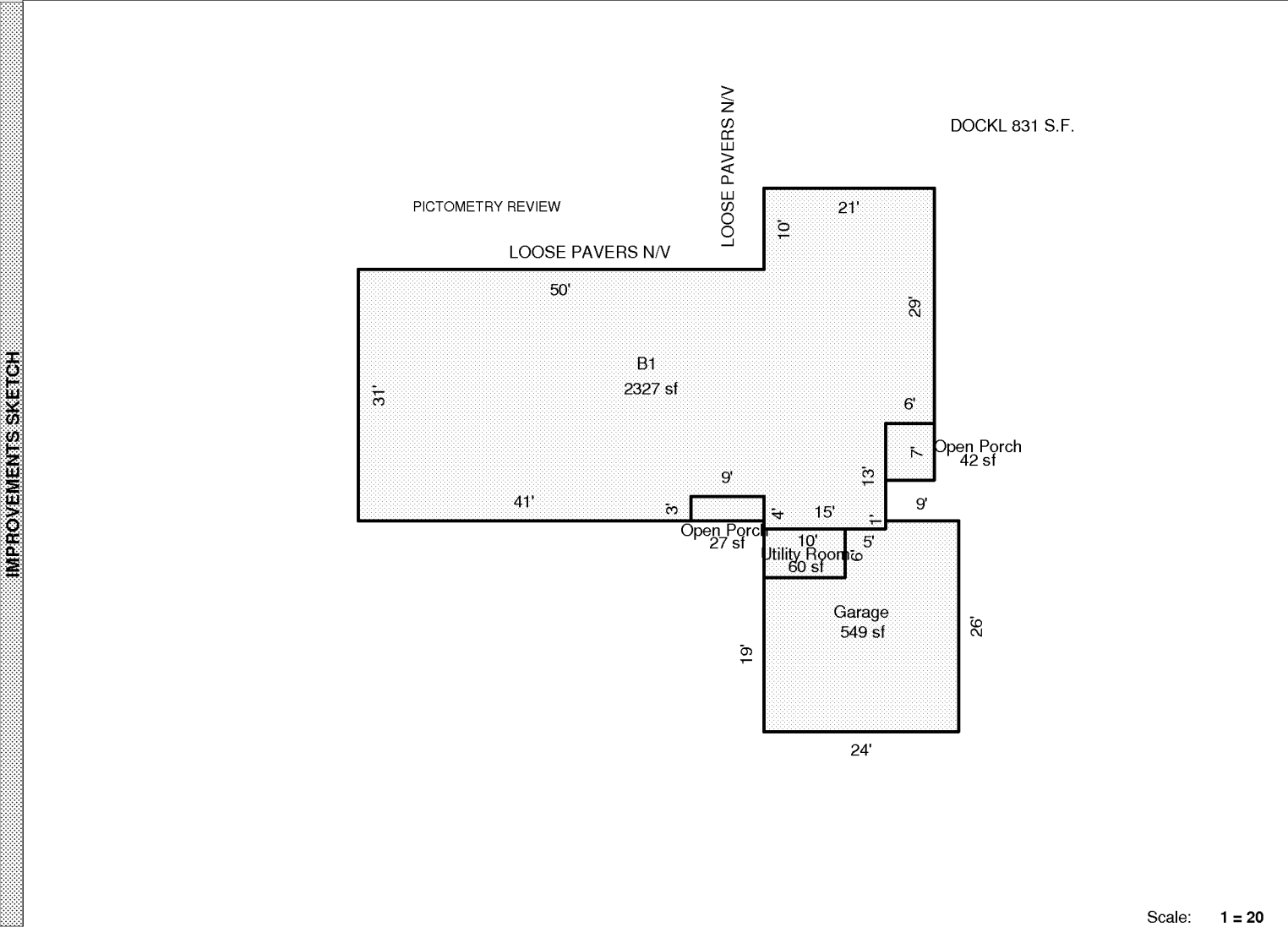

Scale: 1 = 20

AREA CALCULATIONS SUMMARY						Comment Table 1	
Code	Description	Factor	Net Size	Perimeter	Net Totals		
B1	B1	1.00	2327	232	2327		
GA	Garage	1.00	549	100	549		
OP	Open Porch	1.00	42	26			
	Open Porch	1.00	27	24	69		
UT	Utility Room	1.00	60	32	60		

Comment Table 2	Comment Table 3