

# SKETCH/AREA TABLE ADDENDUM

Parcel No 3/7/08

File No 2520637

Property Address 25372701-17

City COCOA BEACH

County BREVARD

State FL

Zip 32931

Owner NA

Client 17

Client Address 74 RIVER FALLS DR

Appraiser Name THL

Inspection Date MELBOURNE

SUBJECT

IMPROVEMENTS SKETCH

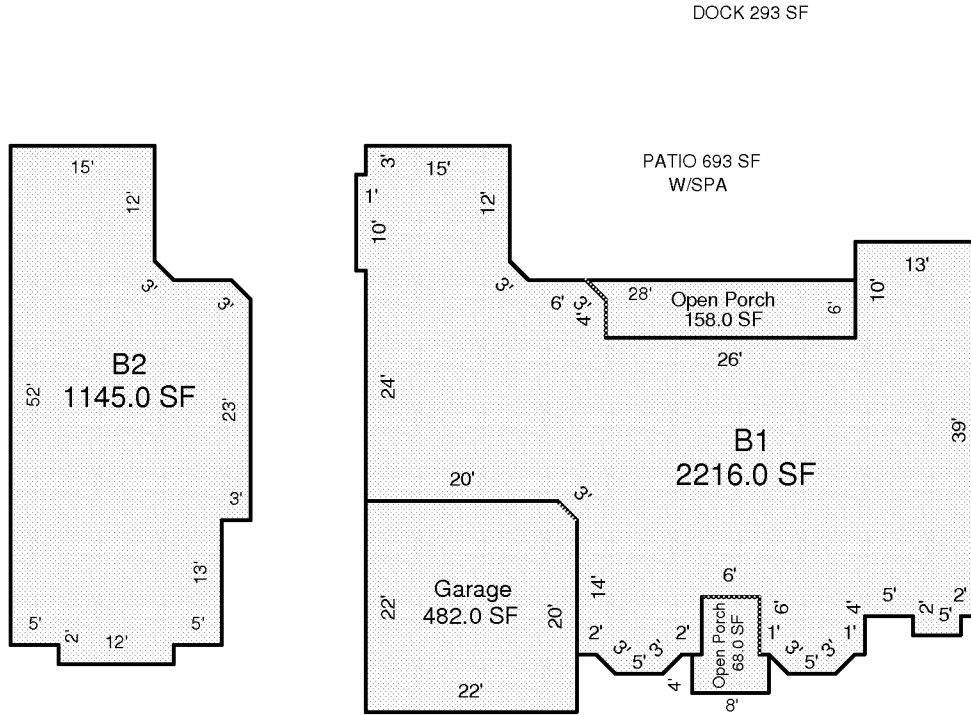

Scale: 1 = 20

AREA CALCULATIONS

### AREA CALCULATIONS SUMMARY

Code	Description	Factor	Net Size	Perimeter	Net Totals
B1	B1	1.00	2216.0	271.8	2216.0
B2	B2	1.00	1145.0	155.7	1145.0
GA	Garage	1.00	482.0	86.8	482.0
OP	Open Porch	1.00	68.0	36.0	
	Open Porch	1.00	158.0	66.8	226.0

### Comment Table 1

--	--

### Comment Table 2

### Comment Table 3

--	--