

SKETCH/AREA TABLE ADDENDUM

DATE 9/30/10

RE # 2519940

SUBJECT

PARCEL ID 25 3723DP A 3			
CITY COCOA BEACH	COUNTY Brevard	STATE FL	ZIP 32931
PERMIT #			
MARKET AREA 17	ADDRESS 1519 BAY SHORE DR		
APPRAISER NAME JDI	BRANCH OFFICE TITUSVILLE		

IMPROVEMENTS SKETCH

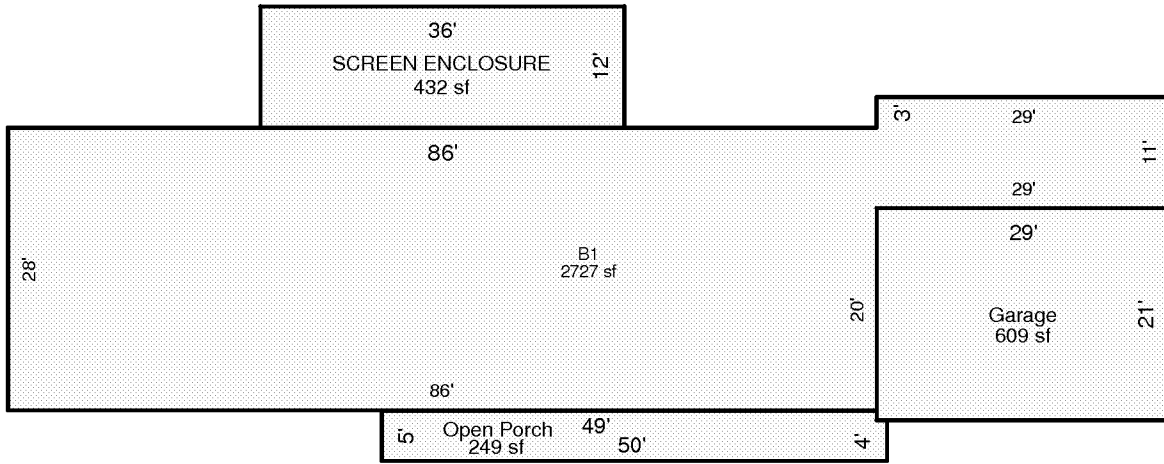

Scale: 1 = 19

AREA CALCULATIONS

AREA CALCULATIONS SUMMARY

Code	Description	Factor	Net Size	Perimeter	Net Totals
B1	B1	1.00	2727	292	2727
GA	Garage	1.00	609	100	609
OP	Open Porch	1.00	249	110	249
SCREEN ENCLOSURE	SCREEN ENCLOSURE	1.00	432	96	432

Comment Table 1

--

Comment Table 2

Comment Table 3

--	--