

SKETCH/AREA TABLE ADDENDUM

DATE 9/30/10

RE # 2519934

SUBJECT

PARCEL ID 25 3723DO 12				
CITY COCOA BEACH	COUNTY BREVARD	STATE FL	ZIP 32931	
PERMIT #				
MARKET AREA 17	ADDRESS 1505 BAY SHORE DRIVE			
APPRAISER NAME JDI	BRANCH OFFICE TITUSVILLE			

IMPROVEMENTS SKETCH

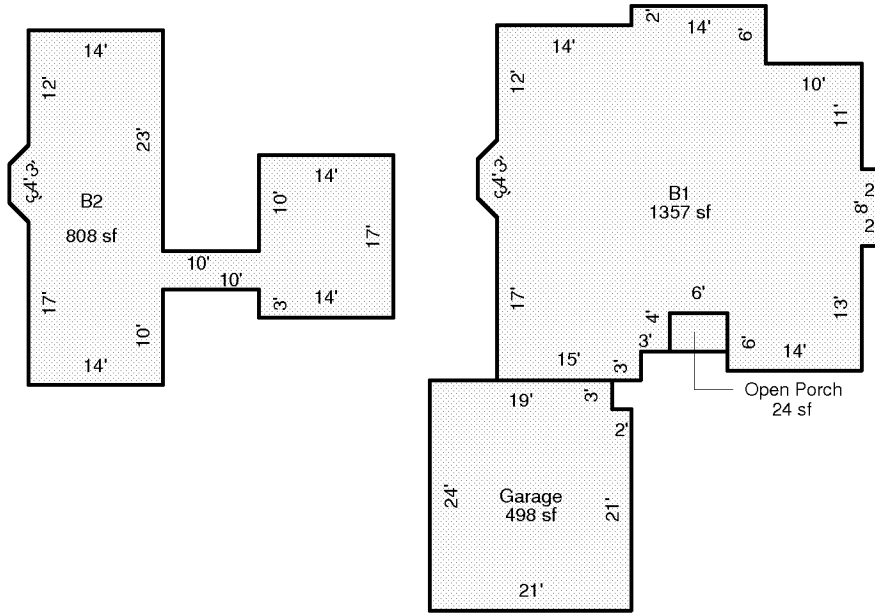

Scale: 1 = 20

AREA CALCULATIONS

AREA CALCULATIONS SUMMARY

Code	Description	Factor	Net Size	Perimeter	Net Totals
B1	B1	1.00	1357	172	1357
B2	B2	1.00	808	178	808
GA	Garage	1.00	498	90	498
OP	Open Porch	1.00	24	20	24
