

# SKETCH/AREA TABLE ADDENDUM

DATE 12.02.10

RE # 2519327

|         |                            |                              |                |          |           |
|---------|----------------------------|------------------------------|----------------|----------|-----------|
| SUBJECT | PARCEL ID 25 37 19 IG D 16 | CITY MERRITT ISLAND          | COUNTY Brevard | STATE FL | ZIP 32952 |
|         | PERMIT #                   |                              |                |          |           |
|         | MARKET AREA 19             | ADDRESS 1380 LESLIE DR       |                |          |           |
|         | APPRAISER NAME JCA         | BRANCH OFFICE MERRITT ISLAND |                |          |           |
|         |                            |                              |                |          |           |

IMPROVEMENTS SKETCH

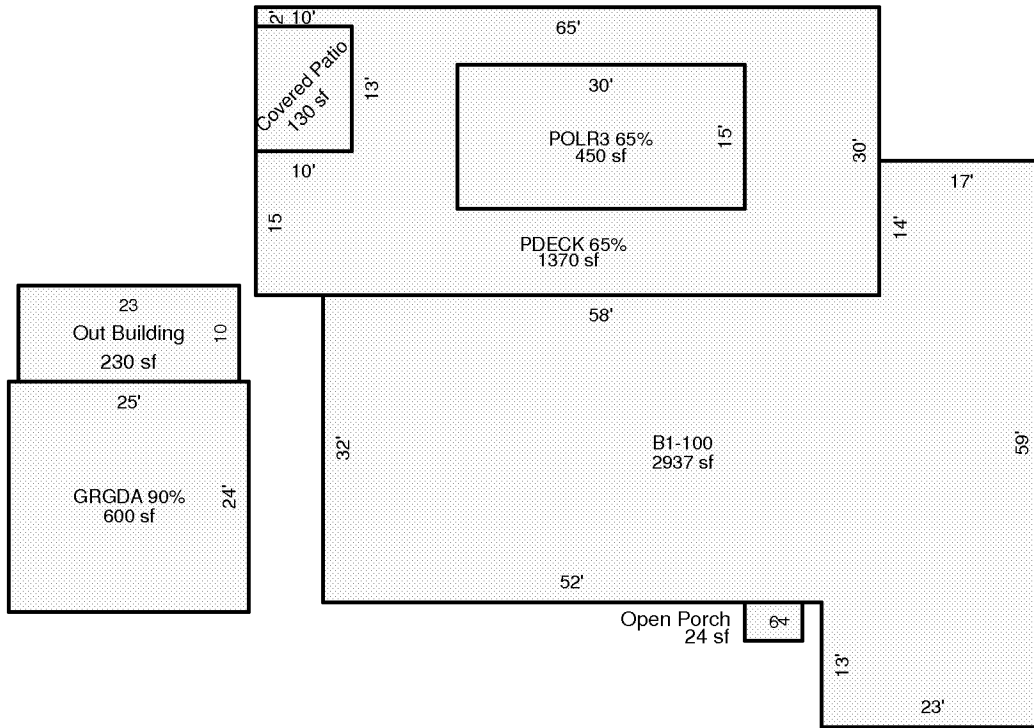

Scale: 1 = 20

AREA CALCULATIONS

| AREA CALCULATIONS SUMMARY |               |        |          |           |            |
|---------------------------|---------------|--------|----------|-----------|------------|
| Code                      | Description   | Factor | Net Size | Perimeter | Net Totals |
| B1                        | B1-100        | 1.00   | 2937     | 268       | 2937       |
| OP                        | Open Porch    | 1.00   | 24       | 20        | 24         |
| CVPRT                     | Covered Patio | 1.00   | 130      | 46        | 130        |
| OBLD                      | Out Building  | 1.00   | 230      | 66        | 230        |
| PDECK                     | PDECK 65%     | 1.00   | 1370     | 210       | 1370       |
| POOL                      | POLR3 65%     | 1.00   | 450      | 90        | 450        |
| GARAGE                    | GRGDA 90%     | 1.00   | 600      | 98        | 600        |

|                 |                 |
|-----------------|-----------------|
| Comment Table 1 |                 |
|                 |                 |
| Comment Table 2 | Comment Table 3 |
|                 |                 |