

# SKETCH/AREA TABLE ADDENDUM

Parcel No 4/18/07

File No 2518861

Property Address 25-37-15-09-25

City COCOA BEACH

County BREVARD

State FL

Zip 32931

Owner

Client Client Address 111 LA RIVIERE RD

Appraiser Name JEC

Inspection Date PALM BAY

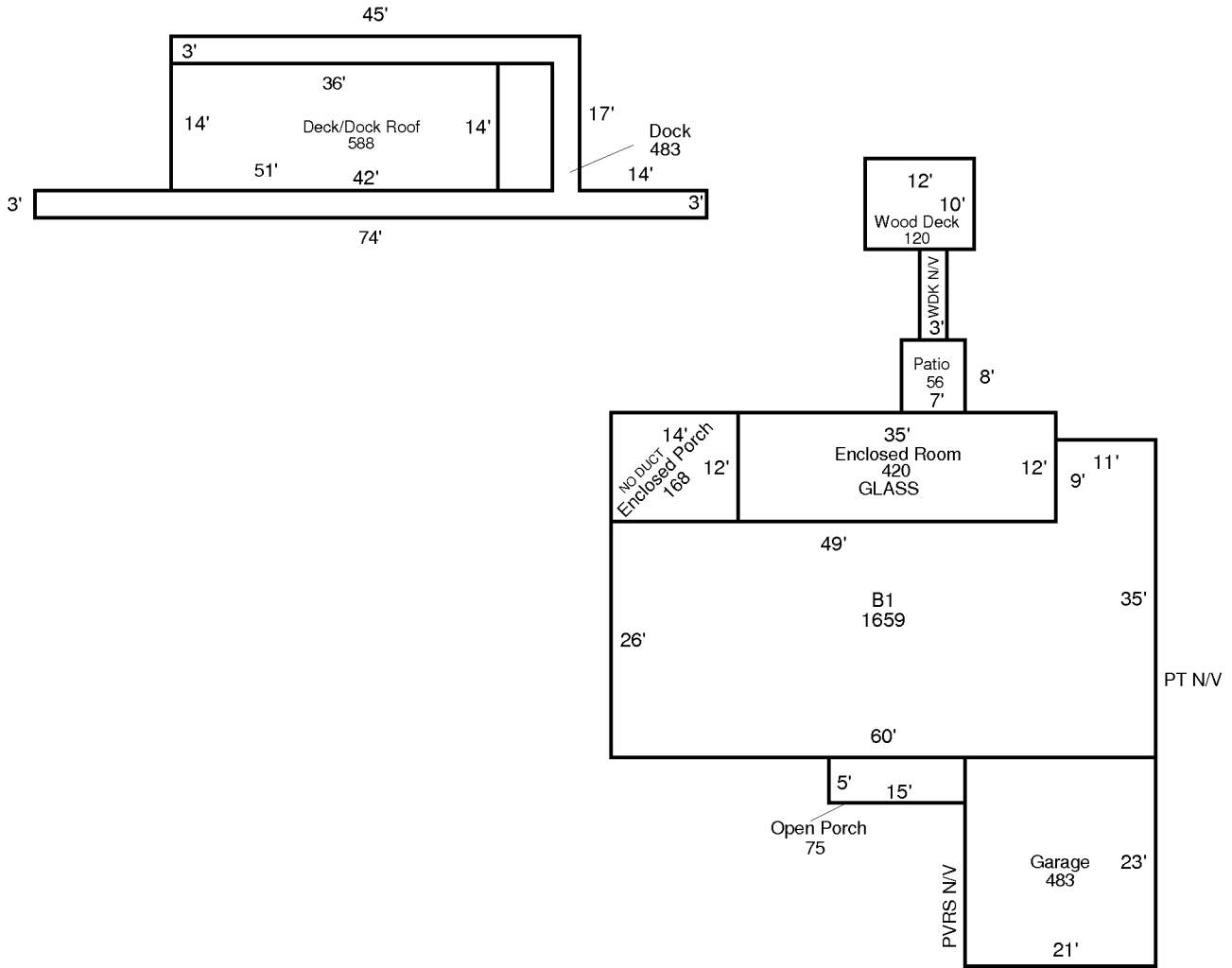

## AREA CALCULATIONS SUMMARY

| Code  | Description    | Factor | Net Size | Perimeter | Net Totals |
|-------|----------------|--------|----------|-----------|------------|
| B1    | B1             | 1.00   | 1659     | 190       | 1659       |
| GA    | Garage         | 1.00   | 483      | 88        | 483        |
| EP    | Enclosed Porch | 1.00   | 168      | 52        | 168        |
| OP    | Open Porch     | 1.00   | 75       | 40        | 75         |
| PT    | Patio          | 1.00   | 56       | 30        | 56         |
| DOCK  | Dock           | 1.00   | 483      | 260       | 483        |
| DROOF | Deck/Dock Roof | 1.00   | 588      | 112       | 588        |
| ENCLR | Enclosed Room  | 1.00   | 420      | 94        | 420        |
| WDECK | Wood Deck      | 1.00   | 120      | 44        | 120        |

### Comment Table 1

|  |
|--|
|  |
|--|

### Comment Table 2

### Comment Table 3

|  |  |
|--|--|
|  |  |
|--|--|