

# SKETCH/AREA TABLE ADDENDUM

Date 13 AUG. 2009

RE # 2518647

<b>SUBJECT</b>	Parcel ID 25 371502 1 11
City COCOA BEACH	County BREVARD State FL Zip 32931
Permit # NONE	
Market Area 17	Address 120 SUNSET DR.
Appraiser Name WHS	Branch Office TITUSVILLE

**IMPROVEMENTS SKETCH**

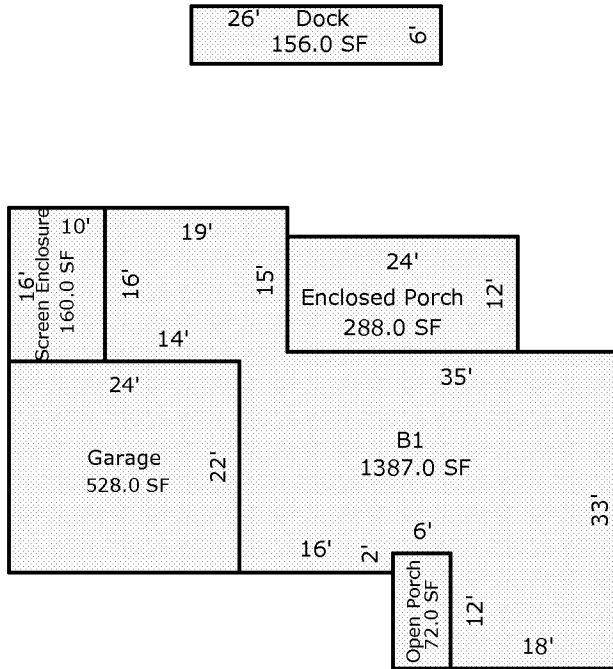

Scale: 1 = 20

**AREA CALCULATIONS**

### AREA CALCULATIONS SUMMARY

Code	Description	Factor	Net Size	Perimeter	Net Totals
B1	B1	1.00	1387.0	208.0	1387.0
GA	Garage	1.00	528.0	92.0	528.0
EP	Enclosed Porch	1.00	288.0	72.0	288.0
OP	Open Porch	1.00	72.0	36.0	72.0
DOCK	Dock	1.00	156.0	64.0	156.0
SCREN	Screen Enclosure	1.00	160.0	52.0	160.0

#### Comment Table 1

#### Comment Table 2

#### Comment Table 3