

SKETCH/AREA TABLE ADDENDUM

File No 2517194

Property Address 25 37 10 79 N2 25

City COCOA BEACH

County Brevard

State FL

Zip 32931

Owner

Client 18

Client Address 25 BOUGAINVILLEA DR

Appraiser Name M24 DRAW / M12 FIELD

Inspection Date MI

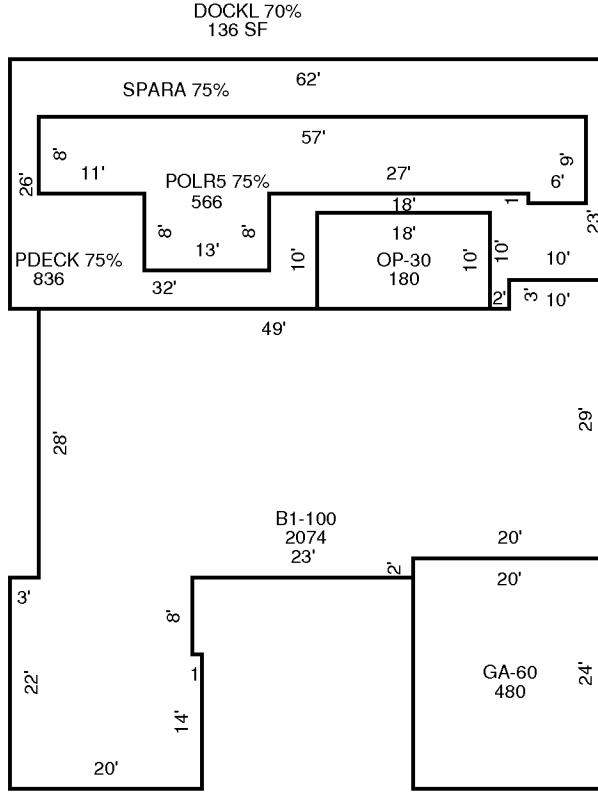

AREA CALCULATIONS SUMMARY

Code	Description	Factor	Net Size	Perimeter	Net Totals
B1	B1-100	1.00	2074	232	2074
GA7	GA-60	1.00	480	88	480
OP4	OP-30	1.00	180	56	180
PDECK	PDECK 75%	1.00	836	196	836
POOL	POLR5 75%	1.00	566	148	566

Comment Table 1

Comment Table 2

Comment Table 3