

SKETCH/AREA TABLE ADDENDUM

DATE **MARCH 2 2010**

RE # **2517153**

SUBJECT

PARCEL ID 25-37-10-79-N1-17				
CITY COCOA BEACH	COUNTY BREVARD	STATE FLORIDA	ZIP 32931	
PERMIT # PICTO REVIEW				
MARKET AREA 17	ADDRESS 17 AZALEA DR			
APPRAISER NAME LWC/DWL	BRANCH OFFICE MERRITT ISLAND			

IMPROVEMENTS SKETCH

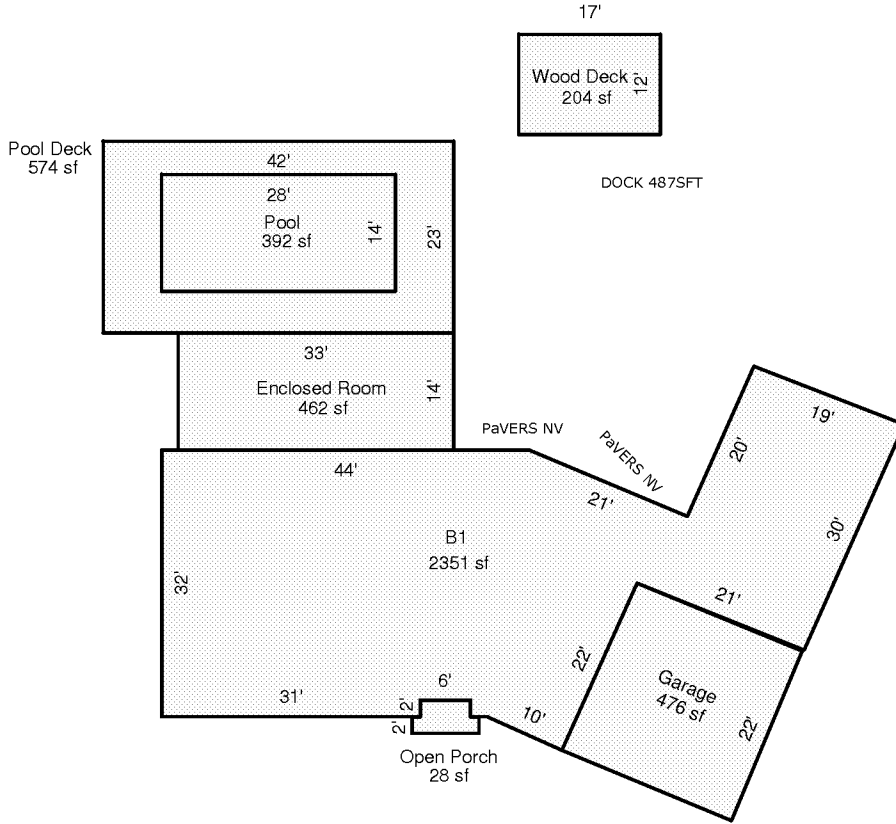

Scale: **1 = 23**

AREA CALCULATIONS

AREA CALCULATIONS SUMMARY

Code	Description	Factor	Net Size	Perimeter	Net Totals
B1	B1	1.00	2351	261	2351
GA	Garage	1.00	476	87	476
OP	Open Porch	1.00	28	24	28
ENCLR	Enclosed Room	1.00	462	94	462
PDECK	Pool Deck	1.00	574	130	574
POOL	Pool	1.00	392	84	392
WDECK	Wood Deck	1.00	204	58	204

Comment Table 1

--	--

Comment Table 2

Comment Table 3

--	--