

SKETCH/AREA TABLE ADDENDUM

DATE 18 MAY, 2010

RE # 2516911

SUBJECT	PARCEL ID 25 371050 3 6	CITY COCOA BEACH	COUNTY BREVARD	STATE FL	ZIP 32931
	PERMIT # 0900000818	ADDRESS 21 CRYSTAL RIVER DR.			
	MARKET AREA 17	BRANCH OFFICE TITUSVILLE			
	APPRaiser NAME WHS				

IMPROVEMENTS SKETCH

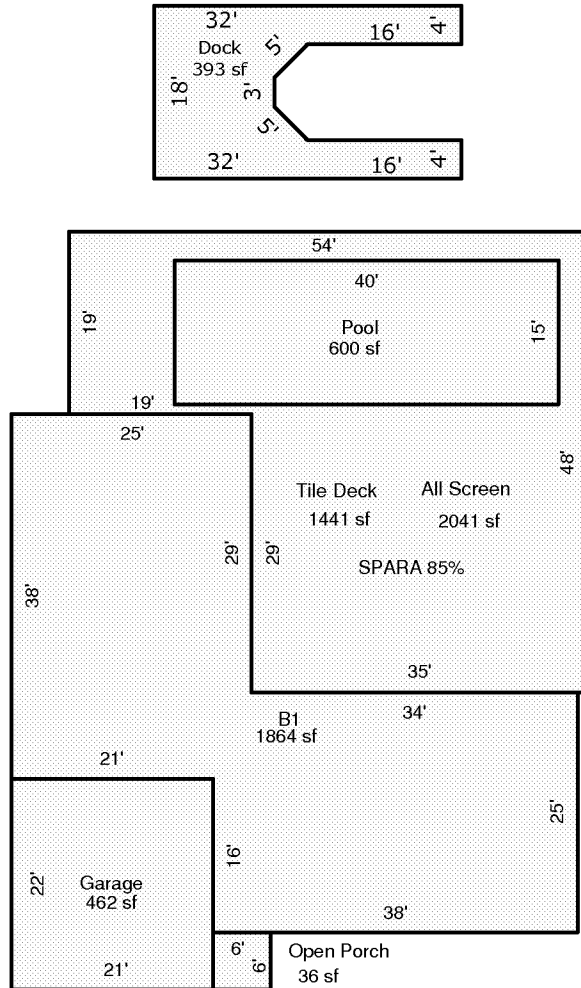

Scale: 1 = 20

AREA CALCULATIONS

AREA CALCULATIONS SUMMARY

Code	Description	Factor	Net Size	Perimeter	Net Totals
B1	B1	1.00	1864	226	1864
GA	Garage	1.00	462	86	462
OP	Open Porch	1.00	36	24	36
ALSCN	All Screen	1.00	2041	204	2041
DOCK	Dock	1.00	393	135	393
POOL	Pool	1.00	600	110	600
TDECK	Tile Deck	1.00	1441	204	1441

Comment Table 1

--	--

Comment Table 2

Comment Table 3

--	--