

SKETCH/AREA TABLE ADDENDUM

DATE 18 MAY, 2010

RE # 2516754

SUBJECT	PARCEL ID 25 371001 G 17	CITY COCOA BEACH	COUNTY BREVARD	STATE FL	ZIP 32931
	PERMIT # 090001443	ADDRESS 813 CATALINA RD.			
	MARKET AREA 17	BRANCH OFFICE TITUSVILLE			
	APPRaiser NAME WHS				

IMPROVEMENTS SKETCH

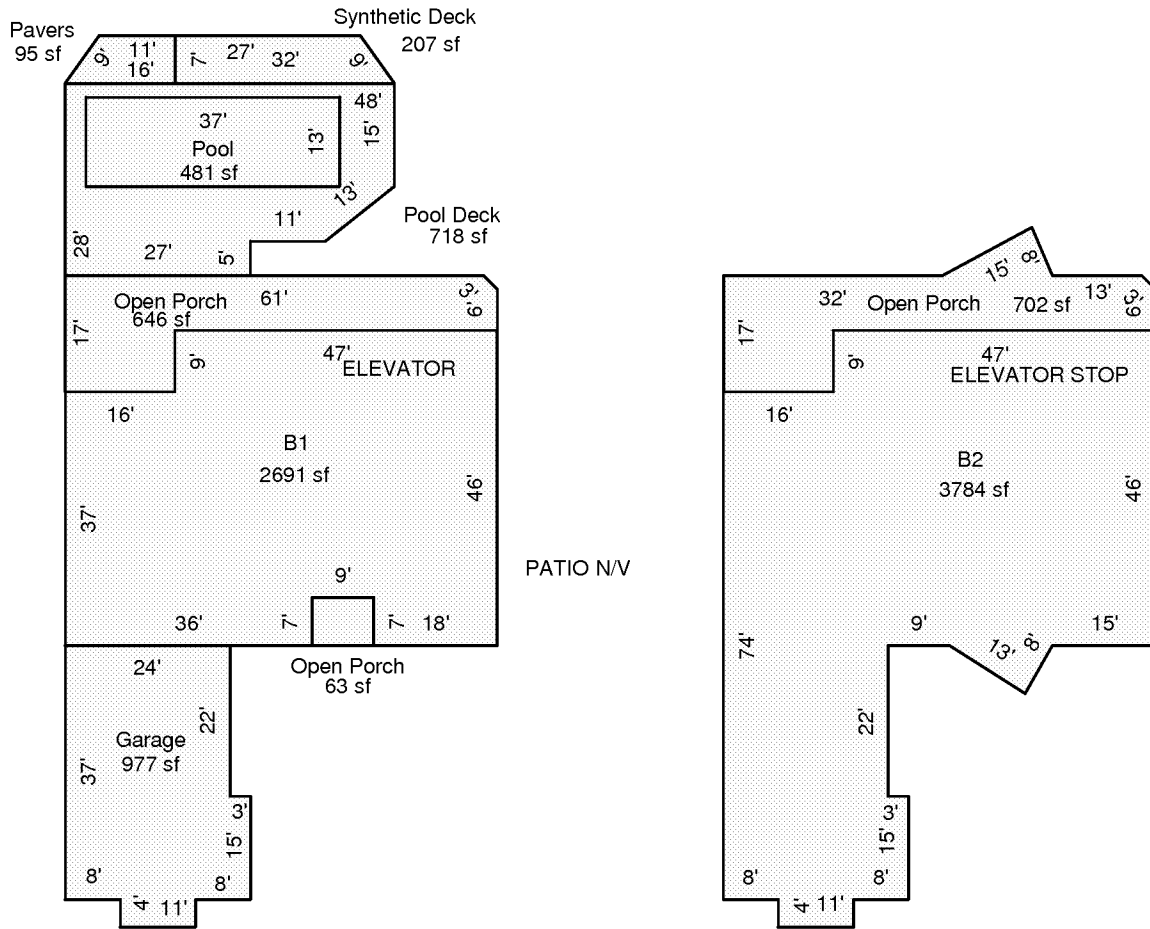

Scale: 1 = 28

AREA CALCULATIONS

AREA CALCULATIONS SUMMARY

Code	Description	Factor	Net Size	Perimeter	Net Totals
B1	B1	1.00	2691	232	2691
B2	B2	1.00	3784	312	3784
GA	Garage	1.00	977	136	977
OP	Open Porch	1.00	63	32	
	Open Porch	1.00	646	159	
	Open Porch	1.00	702	165	1411
PAVST	Pavers	1.00	95	43	95
PDECK	Pool Deck	1.00	718	147	718
POOL	Pool	1.00	481	100	481
SDECK	Synthetic Deck	1.00	207	75	207

Comment Table 1	
Comment Table 2	Comment Table 3