

SKETCH/AREA TABLE ADDENDUM

Date 9-1-09

RE # 2516741

SUBJECT

Parcel ID 25 371001 g 4

City COCOA BEACH

County Brevard

State FL

Zip

Permit #

Market Area 1801 02

Address 538 COCOA ISLES BLVD

Appraiser Name DZC

Branch Office TITUSVILLE

IMPROVEMENTS SKETCH

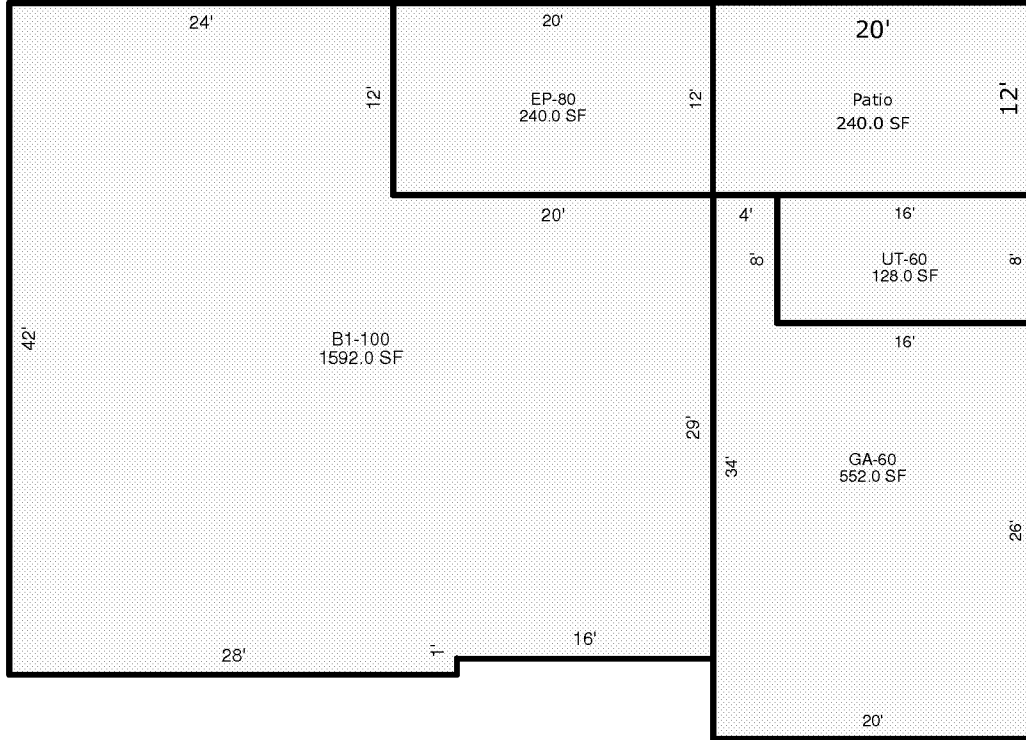

Scale: 1 = 12

AREA CALCULATIONS

AREA CALCULATIONS SUMMARY

Code	Description	Factor	Net Size	Perimeter	Net Totals
B1	B1-100	1.00	1592.0	172.0	1592.0
PT	Patio	1.00	240.0	64.0	240.0
EP5	EP-80	1.00	240.0	64.0	240.0
UT7	UT-60	1.00	128.0	48.0	128.0
GA7	GA-60	1.00	552.0	108.0	552.0

Comment Table 1

--	--

Comment Table 2

Comment Table 3

--	--