

SKETCH/AREA TABLE ADDENDUM

Date 8/13/09

RE # 2516738

SUBJECT

Parcel ID	25-37-10-01-G-1		
City	COCOA BEACH	County	BREVARD
		State	FL
Zip	32931		
Permit #	RECHECK		
Market Area	17	Address	704 COCOA ISLES BLVD
Appraiser Name	JEC	Branch Office	TITUSVILLE

IMPROVEMENTS SKETCH

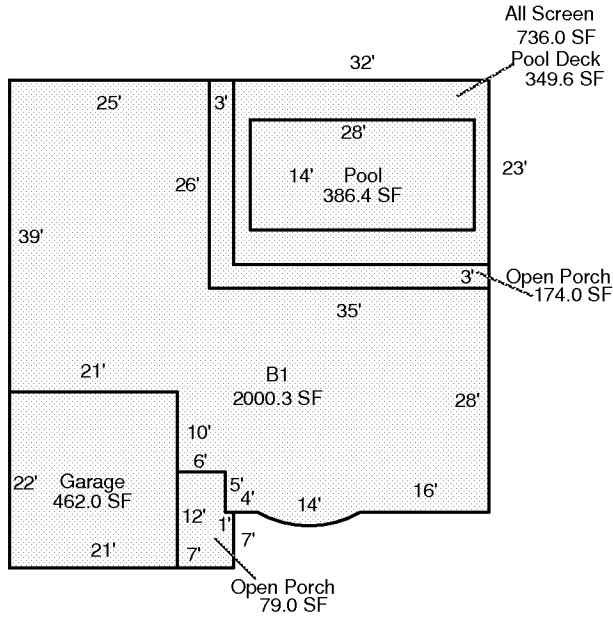

Scale: 1 = 24

AREA CALCULATIONS

AREA CALCULATIONS SUMMARY

Code	Description	Factor	Net Size	Perimeter	Net Totals
B1	B1	1.00	2000.3	228.6	2000.3
GA	Garage	1.00	462.0	86.0	462.0
OP	Open Porch	1.00	79.0	38.0	
	Open Porch	1.00	174.0	122.0	253.0
ALSCN	All Screen	1.00	736.0	110.0	736.0
PDECK	Pool Deck	1.00	349.6	110.0	349.6
POOL	Pool	1.00	386.4	83.6	386.4

Comment Table 1

--	--

Comment Table 2

Comment Table 3

--	--