

SKETCH/AREA TABLE ADDENDUM

File No 2515702

Property Address 25 37 10 CW J 24

City COCOA BEACH

County Brevard

State FL

Zip 32931

Owner

Client 18

Client Address 2061 BALI RD

Appraiser Name M17 DRAW / M19 FIELD

Inspection Date MI

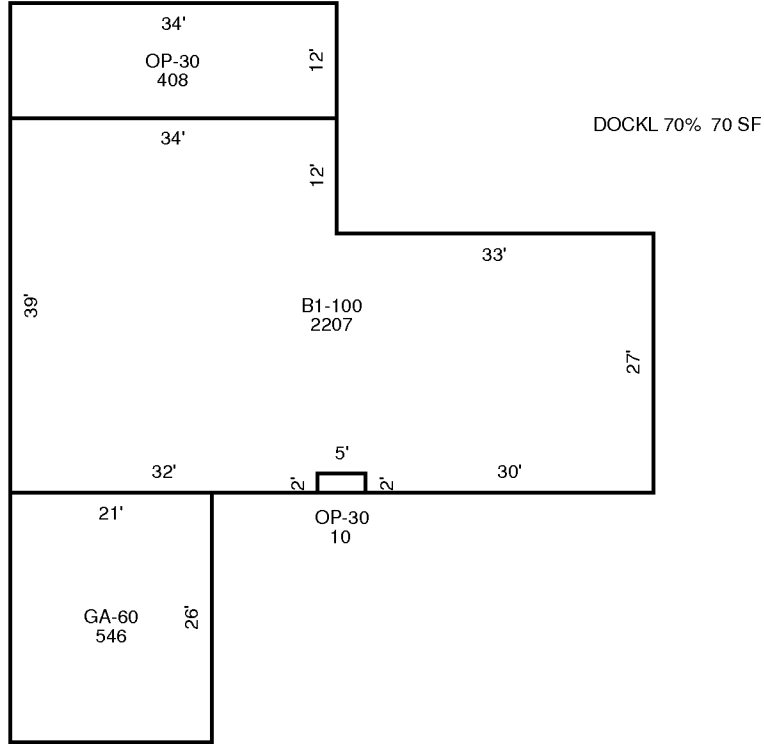

AREA CALCULATIONS SUMMARY

Code	Description	Factor	Net Size	Perimeter	Net Totals
B1	B1-100	1.00	2207	216	2207
GA7	GA-60	1.00	546	94	546
OP4	OP-30	1.00	10	14	
	OP-30	1.00	408	92	418

Comment Table 1

Comment Table 2

Comment Table 3