

# SKETCH/AREA TABLE ADDENDUM

NAME 6-20-07

RE # 2510202

SUBJECT

PARCEL ID 25 361708 6 2

CITY Rockledge

COUNTY Brevard

STATE FL

ZIP

PERMIT #

MARKET AREA

ADDRESS 1013 Woodsmere Pkwy.

APPRAISER NAME Danniell Cordero

BRANCH OFFICE Merrit Island

IMPROVEMENTS SKETCH

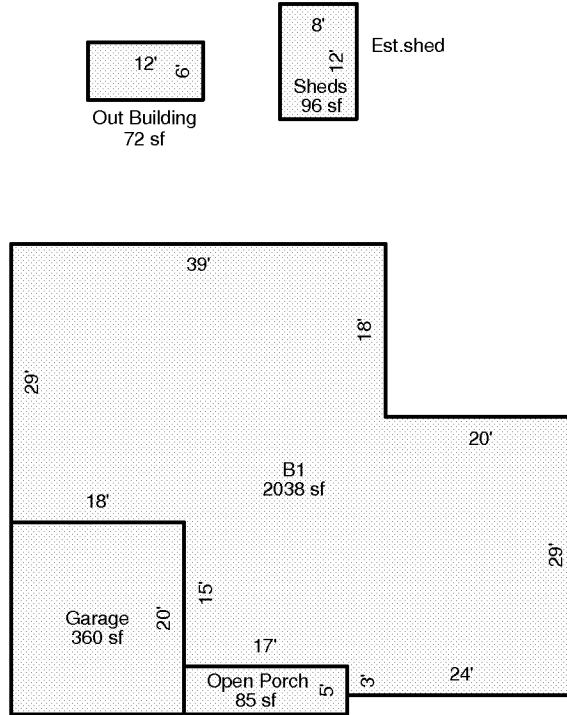

AREA CALCULATIONS

### AREA CALCULATIONS SUMMARY

Code	Description	Factor	Net Size	Perimeter	Net Totals
B1	B1	1.00	2038	212	2038
GA	Garage	1.00	360	76	360
OP	Open Porch	1.00	85	44	85
OBLD	Out Building	1.00	72	36	72
SHED	Sheds	1.00	96	40	96

#### Comment Table 1

--	--

#### Comment Table 2

#### Comment Table 3

--	--