

SKETCH/AREA TABLE ADDENDUM

Parcel No 11-27-07

File No 2459936

Property Address 24 35251 H 4

City COCOA

County BREVARD

State FL

Zip 32926

Owner 010211294

Client 07

Client Address 3758 Chambers Ln Unit 4

Appraiser Name DZC

Inspection Date Titusville

SUBJECT

IMPROVEMENTS SKETCH

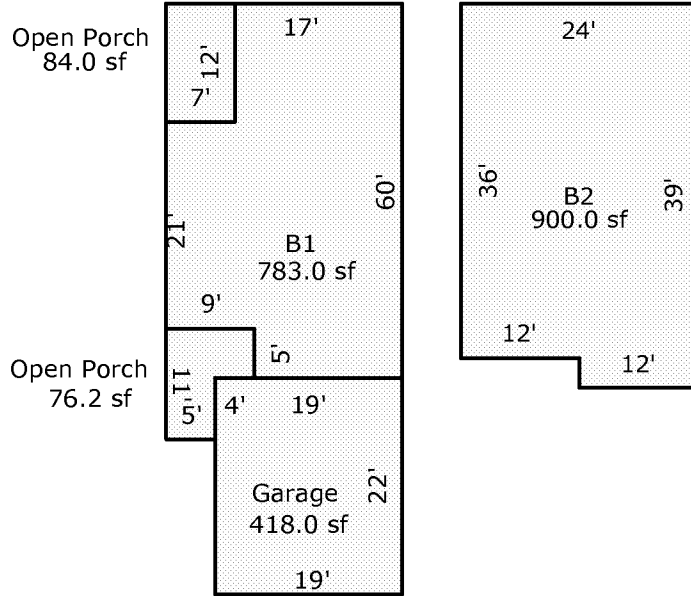

Scale: 1 = 20

AREA CALCULATIONS

AREA CALCULATIONS SUMMARY

Code	Description	Factor	Net Size	Perimeter	Net Totals
B1	B1	1.00	783.0	176.0	783.0
B2	B2	1.00	900.0	126.0	900.0
GA	Garage	1.00	418.0	82.0	418.0
OP	Open Porch	1.00	76.2	40.5	
	Open Porch	1.00	84.0	38.0	160.2

Comment Table 1

--	--

Comment Table 2

Comment Table 3

--	--