

SKETCH/AREA TABLE ADDENDUM

DATE 28 JUNE, 2010

RE # 2458850

SUBJECT

PARCEL ID	24 352751	C	17			
CITY	COCOA	COUNTY	BREVARD	STATE	FL	ZIP 32926
PERMIT #	NONE					
MARKET AREA	07	ADDRESS	624 DRYDEN CIR.			
APPRAISER NAME	WHS	BRANCH OFFICE	TITUSVILLE			

IMPROVEMENTS SKETCH

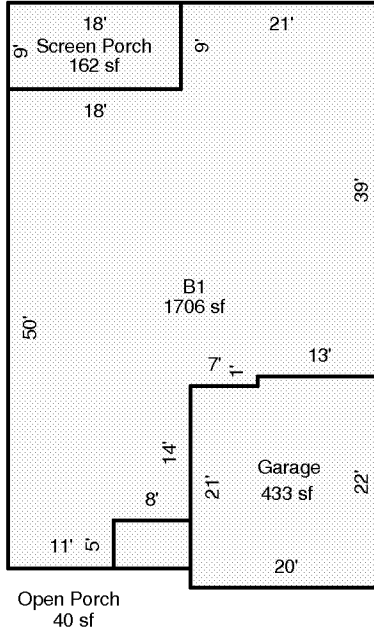

Scale: 1 = 20

AREA CALCULATIONS

AREA CALCULATIONS SUMMARY

Code	Description	Factor	Net Size	Perimeter	Net Totals
B1	B1	1.00	1706	196	1706
GA	Garage	1.00	433	84	433
OP	Open Porch	1.00	40	26	40
SP	Screen Porch	1.00	162	54	162
