

SKETCH/AREA TABLE ADDENDUM

DATE 28 JUNE, 2010

RE # 2458845

SUBJECT

PARCEL ID	24 352751	C	12			
CITY	COCOA	COUNTY	BREVARD	STATE	FL	ZIP 32926
PERMIT #	NONE					
MARKET AREA	07			ADDRESS	674 DRYDEN CIR.	
APPRAISER NAME	WHS			BRANCH OFFICE	TITUSVILLE	

IMPROVEMENTS SKETCH

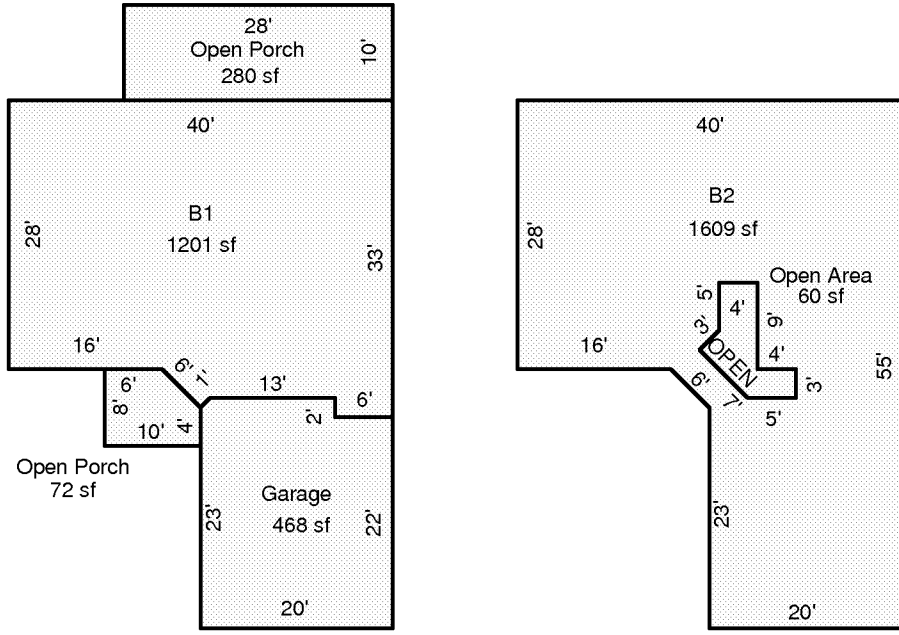

Scale: 1 = 20

AREA CALCULATIONS

AREA CALCULATIONS SUMMARY

Code	Description	Factor	Net Size	Perimeter	Net Totals
B1	B1	1.00	1201	145	1201
B2	B2	1.00	1609	188	1609
GA	Garage	1.00	468	87	468
OP	Open Porch	1.00	72	34	
	Open Porch	1.00	280	76	352
OPEN AREA	Open Area	1.00	60	40	60

Comment Table 1

--

Comment Table 2

Comment Table 3

--	--