

SKETCH/AREA TABLE ADDENDUM

DATE 28 JUNE 2010

RE # 2458835

SUBJECT

PARCEL ID 24 352751 C 2			
CITY COCOA	COUNTY BREVARD	STATE FL	ZIP 32926
PERMIT # NONE			
MARKET AREA 07	ADDRESS 774 DRYDEN CIR.		
APPRAISER NAME WHS	BRANCH OFFICE TITUSVILLE		

IMPROVEMENTS SKETCH

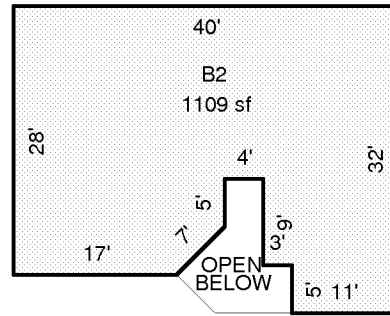
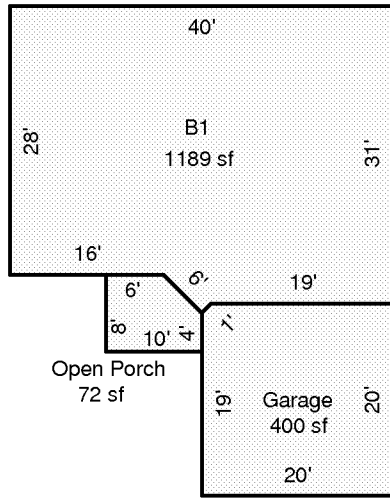

Scale: 1 = 20

AREA CALCULATIONS

AREA CALCULATIONS SUMMARY

Code	Description	Factor	Net Size	Perimeter	Net Totals
B1	B1	1.00	1189	141	1189
B2	B2	1.00	1109	161	1109
GA	Garage	1.00	400	79	400
OP	Open Porch	1.00	72	34	72
