

SKETCH/AREA TABLE ADDENDUM

DATE **NOVEMBER 23 2009**

RE # **2456913**

SUBJECT

PARCEL ID 24 35 27 50 B 14			
CITY COCOA	COUNTY BREVARD	STATE FL	ZIP 32926
PERMIT # PICTO REVIEW			
MARKET AREA 7		ADDRESS 631 CRESSA CIRCLE	
APPRAISER NAME KGR/DWL		BRANCH OFFICE MERRITT ISLAND	

IMPROVEMENTS SKETCH

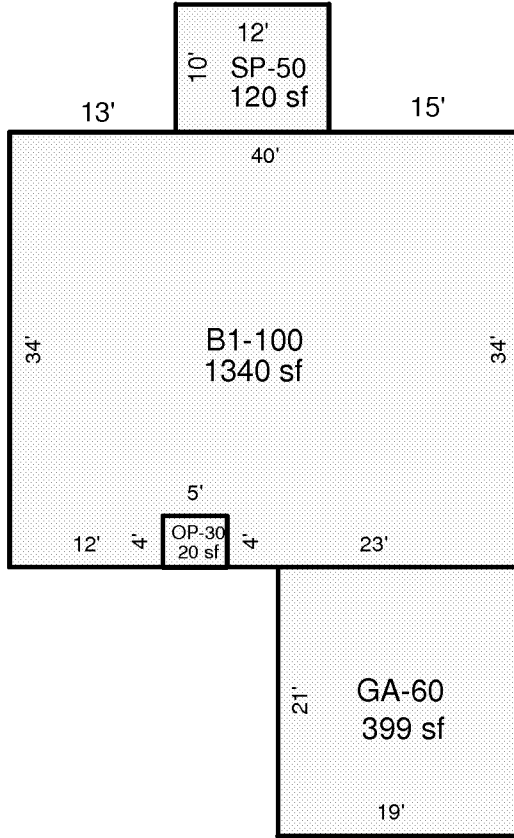

Scale: **1 = 15**

AREA CALCULATIONS

AREA CALCULATIONS SUMMARY

Code	Description	Factor	Net Size	Perimeter	Net Totals
B1	B1-100	1.00	1340	156	1340
OP4	OP-30	1.00	20	18	20
SP6	SP-50	1.00	120	44	120
GA7	GA-60	1.00	399	80	399

Comment Table 1

--	--

Comment Table 2 Comment Table 3

--	--